

2.1
2.2

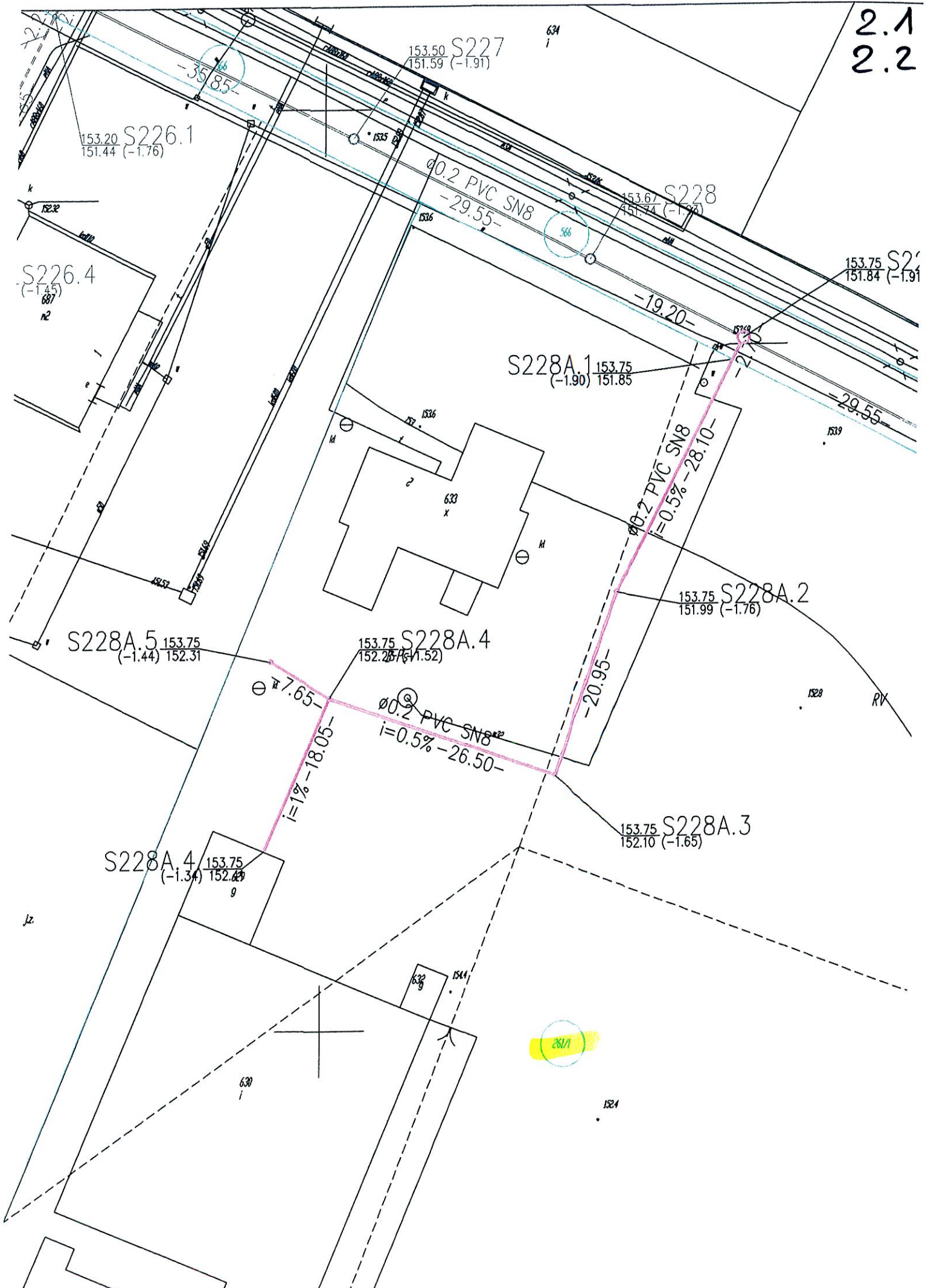

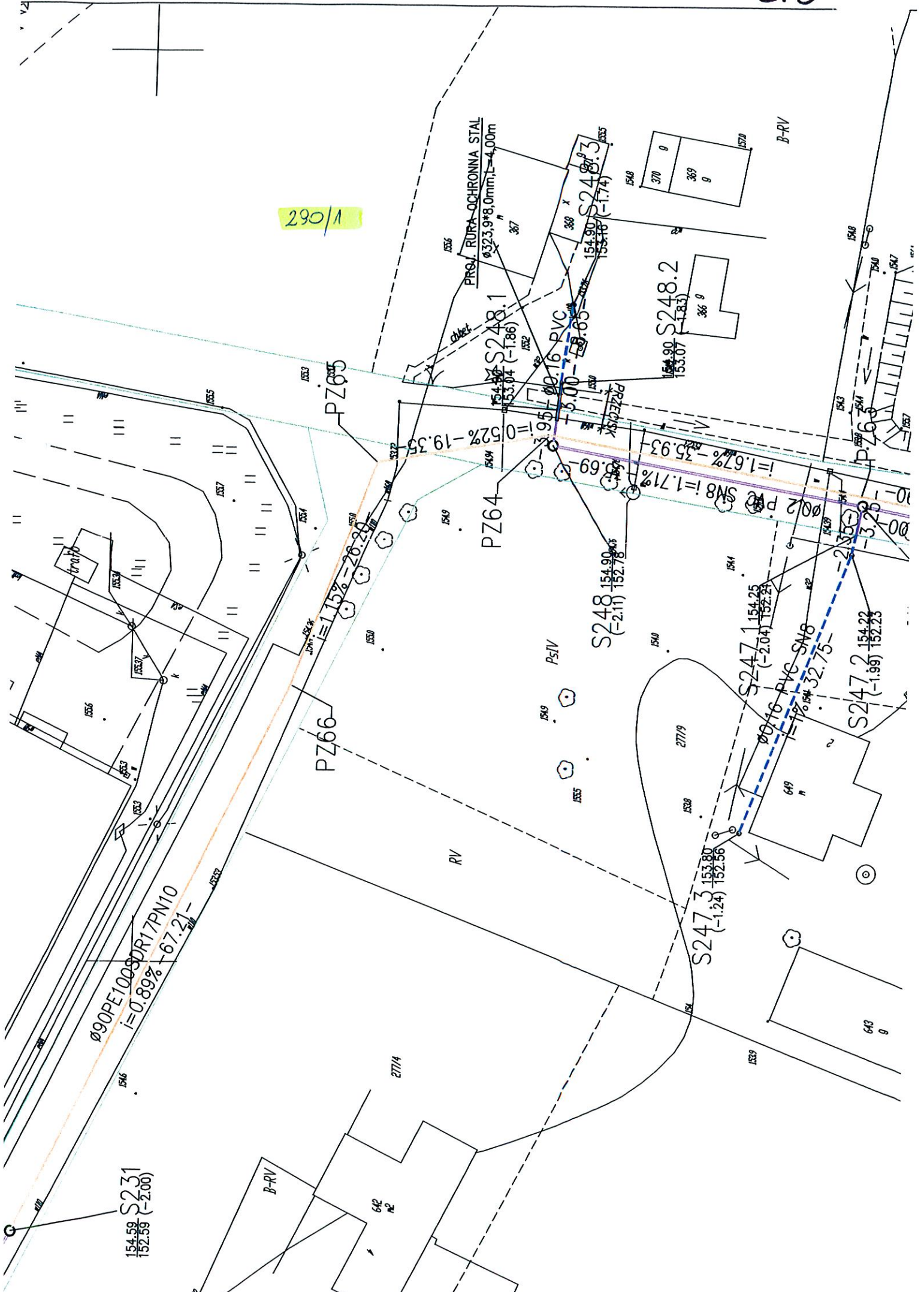

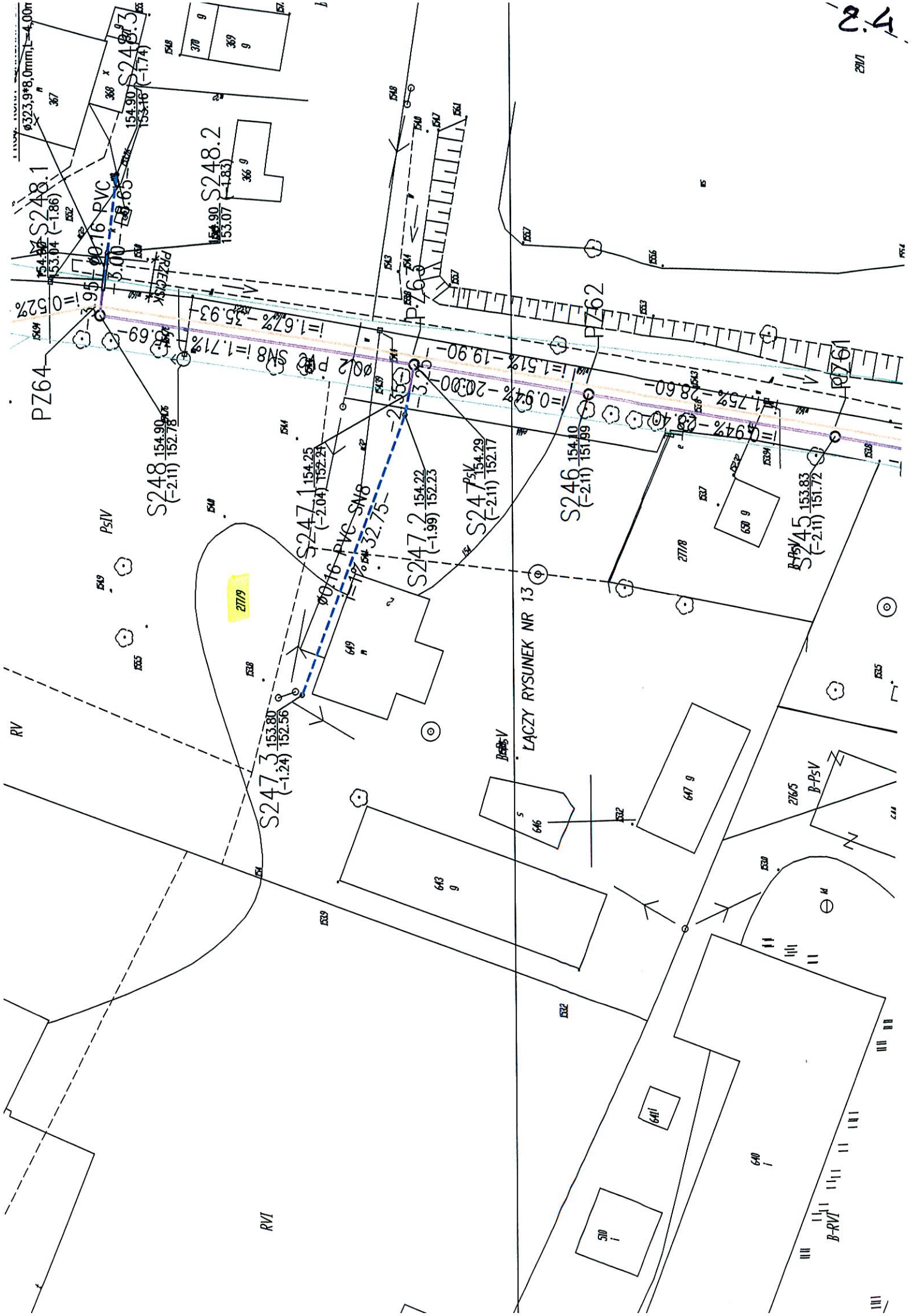

$\phi 323.9 \times 8,0 \text{ mm}, L=4,00 \text{ m}$
 S248.1 (-1.86)
 S248.2 (-1.83)
 S248.3 (-1.74)

PZ64
 S248 (-2.11)
 S247.1 (-2.04)
 S247.2 (-1.99)
 S247.3 (-1.24)
 S247.4 (-2.11)
 S247.5 (-2.11)

PZ65
 S246 (-2.11)
 S247.6 (-2.11)
 S247.7 (-2.11)
 S247.8 (-2.11)
 S247.9 (-2.11)
 S247.10 (-2.11)

PZ66
 S247.11 (-2.11)
 S247.12 (-2.11)
 S247.13 (-2.11)
 S247.14 (-2.11)
 S247.15 (-2.11)

PZ67
 S247.16 (-2.11)
 S247.17 (-2.11)
 S247.18 (-2.11)
 S247.19 (-2.11)
 S247.20 (-2.11)

PZ68
 S247.21 (-2.11)
 S247.22 (-2.11)
 S247.23 (-2.11)
 S247.24 (-2.11)
 S247.25 (-2.11)

PZ69
 S247.26 (-2.11)
 S247.27 (-2.11)
 S247.28 (-2.11)
 S247.29 (-2.11)
 S247.30 (-2.11)

PZ70
 S247.31 (-2.11)
 S247.32 (-2.11)
 S247.33 (-2.11)
 S247.34 (-2.11)
 S247.35 (-2.11)

PZ71
 S247.36 (-2.11)
 S247.37 (-2.11)
 S247.38 (-2.11)
 S247.39 (-2.11)
 S247.40 (-2.11)

PZ72
 S247.41 (-2.11)
 S247.42 (-2.11)
 S247.43 (-2.11)
 S247.44 (-2.11)
 S247.45 (-2.11)

PZ73
 S247.46 (-2.11)
 S247.47 (-2.11)
 S247.48 (-2.11)
 S247.49 (-2.11)
 S247.50 (-2.11)

PZ74
 S247.51 (-2.11)
 S247.52 (-2.11)
 S247.53 (-2.11)
 S247.54 (-2.11)
 S247.55 (-2.11)

PZ75
 S247.56 (-2.11)
 S247.57 (-2.11)
 S247.58 (-2.11)
 S247.59 (-2.11)
 S247.60 (-2.11)

PZ76
 S247.61 (-2.11)
 S247.62 (-2.11)
 S247.63 (-2.11)
 S247.64 (-2.11)
 S247.65 (-2.11)

PZ77
 S247.66 (-2.11)
 S247.67 (-2.11)
 S247.68 (-2.11)
 S247.69 (-2.11)
 S247.70 (-2.11)

PZ78
 S247.71 (-2.11)
 S247.72 (-2.11)
 S247.73 (-2.11)
 S247.74 (-2.11)
 S247.75 (-2.11)

PZ79
 S247.76 (-2.11)
 S247.77 (-2.11)
 S247.78 (-2.11)
 S247.79 (-2.11)
 S247.80 (-2.11)

PZ80
 S247.81 (-2.11)
 S247.82 (-2.11)
 S247.83 (-2.11)
 S247.84 (-2.11)
 S247.85 (-2.11)

PZ81
 S247.86 (-2.11)
 S247.87 (-2.11)
 S247.88 (-2.11)
 S247.89 (-2.11)
 S247.90 (-2.11)

PZ82
 S247.91 (-2.11)
 S247.92 (-2.11)
 S247.93 (-2.11)
 S247.94 (-2.11)
 S247.95 (-2.11)

PZ83
 S247.96 (-2.11)
 S247.97 (-2.11)
 S247.98 (-2.11)
 S247.99 (-2.11)
 S247.100 (-2.11)

PZ84
 S247.101 (-2.11)
 S247.102 (-2.11)
 S247.103 (-2.11)
 S247.104 (-2.11)
 S247.105 (-2.11)

PZ85
 S247.106 (-2.11)
 S247.107 (-2.11)
 S247.108 (-2.11)
 S247.109 (-2.11)
 S247.110 (-2.11)

PZ86
 S247.111 (-2.11)
 S247.112 (-2.11)
 S247.113 (-2.11)
 S247.114 (-2.11)
 S247.115 (-2.11)

PZ87
 S247.116 (-2.11)
 S247.117 (-2.11)
 S247.118 (-2.11)
 S247.119 (-2.11)
 S247.120 (-2.11)

PZ88
 S247.121 (-2.11)
 S247.122 (-2.11)
 S247.123 (-2.11)
 S247.124 (-2.11)
 S247.125 (-2.11)

PZ89
 S247.126 (-2.11)
 S247.127 (-2.11)
 S247.128 (-2.11)
 S247.129 (-2.11)
 S247.130 (-2.11)

PZ90
 S247.131 (-2.11)
 S247.132 (-2.11)
 S247.133 (-2.11)
 S247.134 (-2.11)
 S247.135 (-2.11)

PZ91
 S247.136 (-2.11)
 S247.137 (-2.11)
 S247.138 (-2.11)
 S247.139 (-2.11)
 S247.140 (-2.11)

PZ92
 S247.141 (-2.11)
 S247.142 (-2.11)
 S247.143 (-2.11)
 S247.144 (-2.11)
 S247.145 (-2.11)

PZ93
 S247.146 (-2.11)
 S247.147 (-2.11)
 S247.148 (-2.11)
 S247.149 (-2.11)
 S247.150 (-2.11)

PZ94
 S247.151 (-2.11)
 S247.152 (-2.11)
 S247.153 (-2.11)
 S247.154 (-2.11)
 S247.155 (-2.11)

PZ95
 S247.156 (-2.11)
 S247.157 (-2.11)
 S247.158 (-2.11)
 S247.159 (-2.11)
 S247.160 (-2.11)

PZ96
 S247.161 (-2.11)
 S247.162 (-2.11)
 S247.163 (-2.11)
 S247.164 (-2.11)
 S247.165 (-2.11)

PZ97
 S247.166 (-2.11)
 S247.167 (-2.11)
 S247.168 (-2.11)
 S247.169 (-2.11)
 S247.170 (-2.11)

PZ98
 S247.171 (-2.11)
 S247.172 (-2.11)
 S247.173 (-2.11)
 S247.174 (-2.11)
 S247.175 (-2.11)

PZ99
 S247.176 (-2.11)
 S247.177 (-2.11)
 S247.178 (-2.11)
 S247.179 (-2.11)
 S247.180 (-2.11)

PZ100
 S247.181 (-2.11)
 S247.182 (-2.11)
 S247.183 (-2.11)
 S247.184 (-2.11)
 S247.185 (-2.11)

S247.186 (-2.11)
 S247.187 (-2.11)
 S247.188 (-2.11)
 S247.189 (-2.11)
 S247.190 (-2.11)

S247.191 (-2.11)
 S247.192 (-2.11)
 S247.193 (-2.11)
 S247.194 (-2.11)
 S247.195 (-2.11)

S247.196 (-2.11)
 S247.197 (-2.11)
 S247.198 (-2.11)
 S247.199 (-2.11)
 S247.200 (-2.11)

S247.201 (-2.11)
 S247.202 (-2.11)
 S247.203 (-2.11)
 S247.204 (-2.11)
 S247.205 (-2.11)

S247.206 (-2.11)
 S247.207 (-2.11)
 S247.208 (-2.11)
 S247.209 (-2.11)
 S247.210 (-2.11)

S247.211 (-2.11)
 S247.212 (-2.11)
 S247.213 (-2.11)
 S247.214 (-2.11)
 S247.215 (-2.11)

S247.216 (-2.11)
 S247.217 (-2.11)
 S247.218 (-2.11)
 S247.219 (-2.11)
 S247.220 (-2.11)

S247.221 (-2.11)
 S247.222 (-2.11)
 S247.223 (-2.11)
 S247.224 (-2.11)
 S247.225 (-2.11)

S247.226 (-2.11)
 S247.227 (-2.11)
 S247.228 (-2.11)
 S247.229 (-2.11)
 S247.230 (-2.11)

S247.231 (-2.11)
 S247.232 (-2.11)
 S247.233 (-2.11)
 S247.234 (-2.11)
 S247.235 (-2.11)

S247.236 (-2.11)
 S247.237 (-2.11)
 S247.238 (-2.11)
 S247.239 (-2.11)
 S247.240 (-2.11)

S247.241 (-2.11)
 S247.242 (-2.11)
 S247.243 (-2.11)
 S247.244 (-2.11)
 S247.245 (-2.11)

S247.246 (-2.11)
 S247.247 (-2.11)
 S247.248 (-2.11)
 S247.249 (-2.11)
 S247.250 (-2.11)

S247.251 (-2.11)
 S247.252 (-2.11)
 S247.253 (-2.11)
 S247.254 (-2.11)
 S247.255 (-2.11)

S247.256 (-2.11)
 S247.257 (-2.11)
 S247.258 (-2.11)
 S247.259 (-2.11)
 S247.260 (-2.11)

S247.261 (-2.11)
 S247.262 (-2.11)
 S247.263 (-2.11)
 S247.264 (-2.11)
 S247.265 (-2.11)

S247.266 (-2.11)
 S247.267 (-2.11)
 S247.268 (-2.11)
 S247.269 (-2.11)
 S247.270 (-2.11)

S247.271 (-2.11)
 S247.272 (-2.11)
 S247.273 (-2.11)
 S247.274 (-2.11)
 S247.275 (-2.11)

S247.276 (-2.11)
 S247.277 (-2.11)
 S247.278 (-2.11)
 S247.279 (-2.11)
 S247.280 (-2.11)

S247.281 (-2.11)
 S247.282 (-2.11)
 S247.283 (-2.11)
 S247.284 (-2.11)
 S247.285 (-2.11)

S247.286 (-2.11)
 S247.287 (-2.11)
 S247.288 (-2.11)
 S247.289 (-2.11)
 S247.290 (-2.11)

S247.291 (-2.11)
 S247.292 (-2.11)
 S247.293 (-2.11)
 S247.294 (-2.11)
 S247.295 (-2.11)

S247.296 (-2.11)
 S247.297 (-2.11)
 S247.298 (-2.11)
 S247.299 (-2.11)
 S247.300 (-2.11)

S247.301 (-2.11)
 S247.302 (-2.11)
 S247.303 (-2.11)
 S247.304 (-2.11)
 S247.305 (-2.11)

S247.306 (-2.11)
 S247.307 (-2.11)
 S247.308 (-2.11)
 S247.309 (-2.11)
 S247.310 (-2.11)

S247.311 (-2.11)
 S247.312 (-2.11)
 S247.313 (-2.11)
 S247.314 (-2.11)
 S247.315 (-2.11)

S247.316 (-2.11)
 S247.317 (-2.11)
 S247.318 (-2.11)
 S247.319 (-2.11)
 S247.320 (-2.11)

S247.321 (-2.11)
 S247.322 (-2.11)
 S247.323 (-2.11)
 S247.324 (-2.11)
 S247.325 (-2.11)

S247.326 (-2.11)
 S247.327 (-2.11)
 S247.328 (-2.11)
 S247.329 (-2.11)
 S247.330 (-2.11)

S247.331 (-2.11)
 S247.332 (-2.11)
 S247.333 (-2.11)
 S247.334 (-2.11)
 S247.335 (-2.11)

S247.336 (-2.11)
 S247.337 (-2.11)
 S247.338 (-2.11)
 S247.339 (-2.11)
 S247.340 (-2.11)

S247.341 (-2.11)
 S247.342 (-2.11)
 S247.343 (-2.11)
 S247.344 (-2.11)
 S247.345 (-2.11)

S247.346 (-2.11)
 S247.347 (-2.11)
 S247.348 (-2.11)
 S247.349 (-2.11)
 S247.350 (-2.11)

S247.351 (-2.11)
 S247.352 (-2.11)
 S247.353 (-2.11)
 S247.354 (-2.11)
 S247.355 (-2.11)

S247.356 (-2.11)
 S247.357 (-2.11)
 S247.358 (-2.11)
 S247.359 (-2.11)
 S247.360 (-2.11)

PROJEKT ZAGOSPODAROWANIA TERENU

DATA 16.05.2016

SKALA 1:500

RYS.NR 7

851
866 9

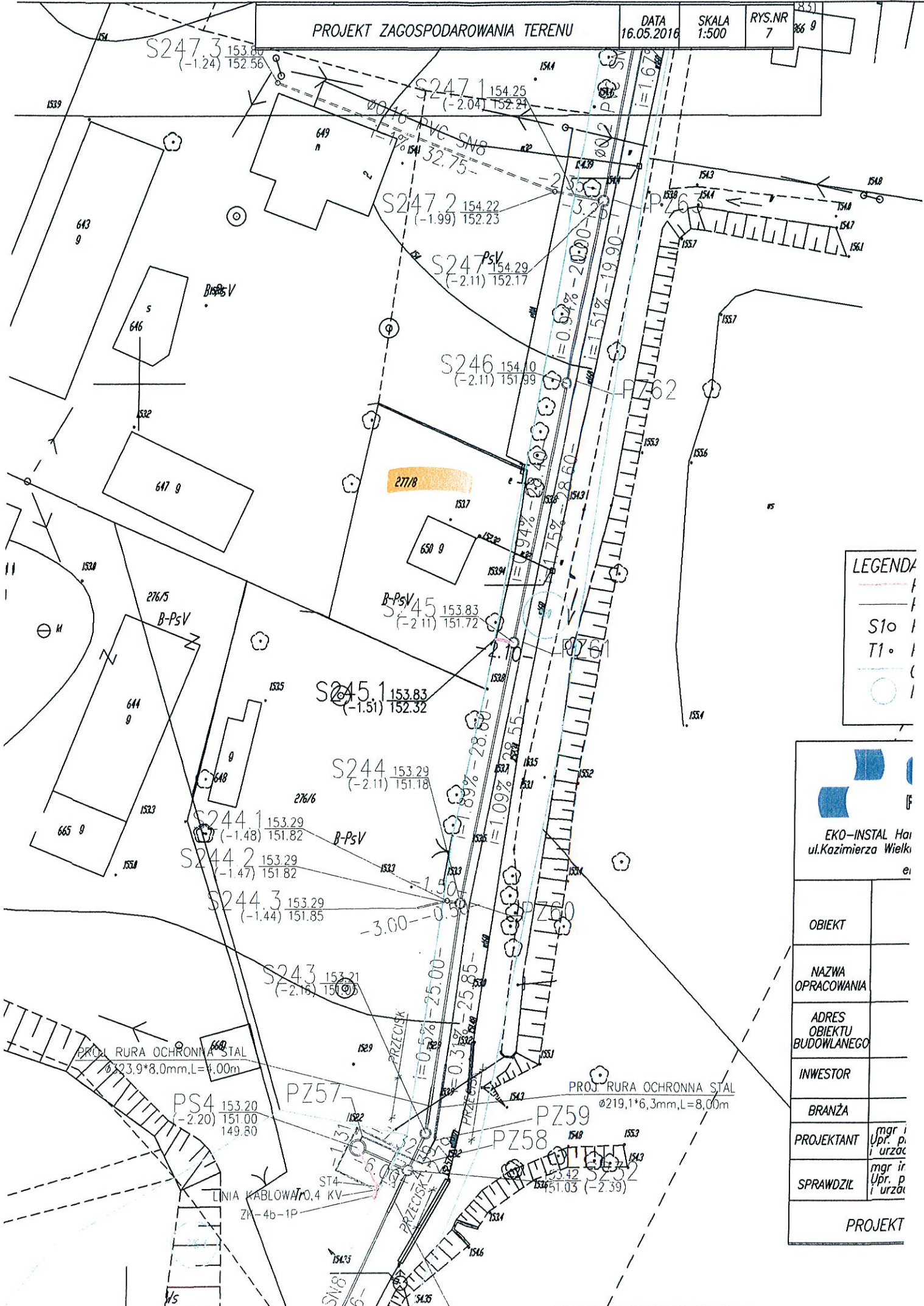

LEGENDA

	f
	S10
	T1
	()

EKO-INSTAL
ul. Kazimierza Wielkiego
ei

OBIEKT	
NAZWA OPRACOWANIA	
ADRES OBIEKTU BUDOWLANEGO	
INWESTOR	
BRANŻA	
PROJEKTANT	mgr i Upr. p. i urzadz
SPRAWDZIL	mgr inż. Upr. p. i urzadz
PROJEKT	

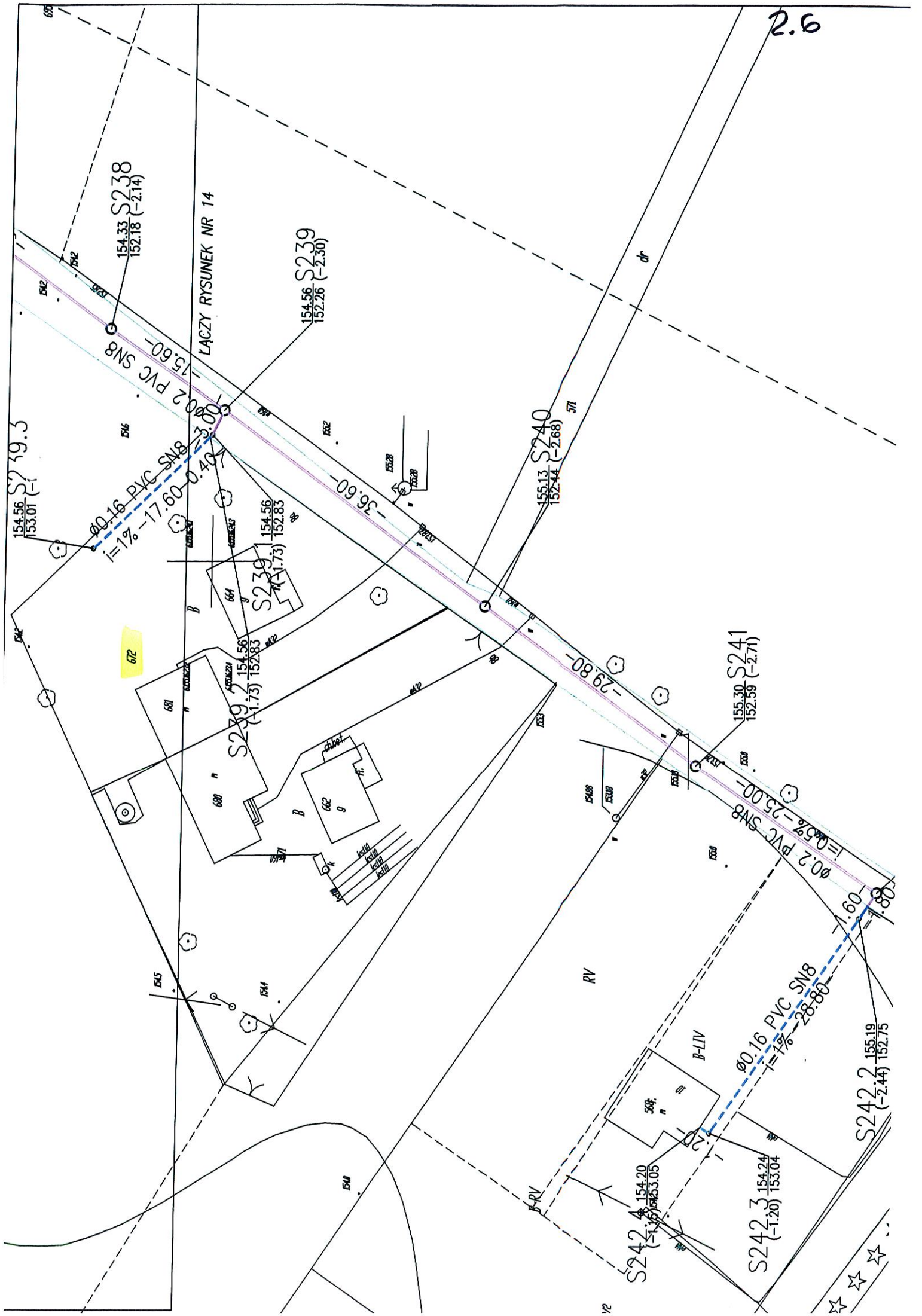

2.6

S238
154.33
152.18 (-2.14)

S239
154.56
152.26 (-2.30)

S239
154.56
152.83 (-1.73)

S240
155.13
152.44 (-2.68)

S241
155.30
152.59 (-2.71)

S242.4
154.20
153.05 (-1.15)

S242.3
154.24
153.04 (-1.20)

S242.2
155.19
152.75 (-2.44)

672

680

681

682

LACZY RYSUNEK NR 14

0.2 PVC SN8
15.60

0.2 PVC SN8
17.60
 $i=1\%$ (-1.73)

0.2 PVC SN8
36.60
 $i=1\%$ (-1.73)

0.2 PVC SN8
25.00
 $i=0.5\%$ (-2.71)

0.2 PVC SN8
28.80
 $i=1\%$ (-1.73)

0.2 PVC SN8
28.80
 $i=1\%$ (-1.73)



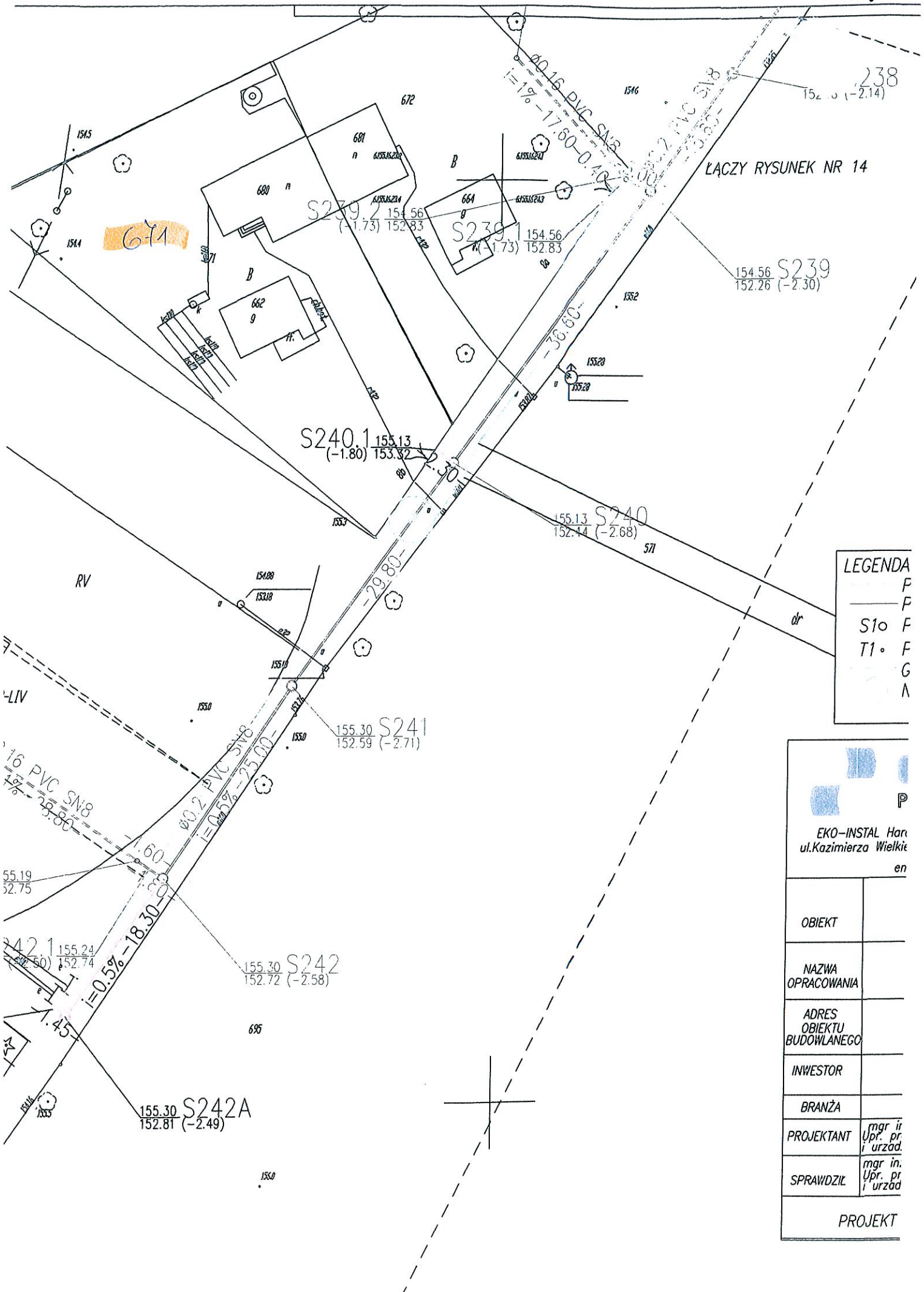

LEGENDA

—	F
—	F
S10	F
T10	F
—	G
—	A

 <p>EKO-INSTAL Haru ul. Kazimierza Wielkie en</p>	
OBIEKT	
NAZWA OPRACOWANIA	
ADRES OBIEKTU BUDOWLANEGO	
INWESTOR	
BRANŻA	
PROJEKTANT	mgr inż. Upr. pr. i urząd.
SPRAWDZIŁ	mgr inż. Upr. pr. i urząd.
PROJEKT	

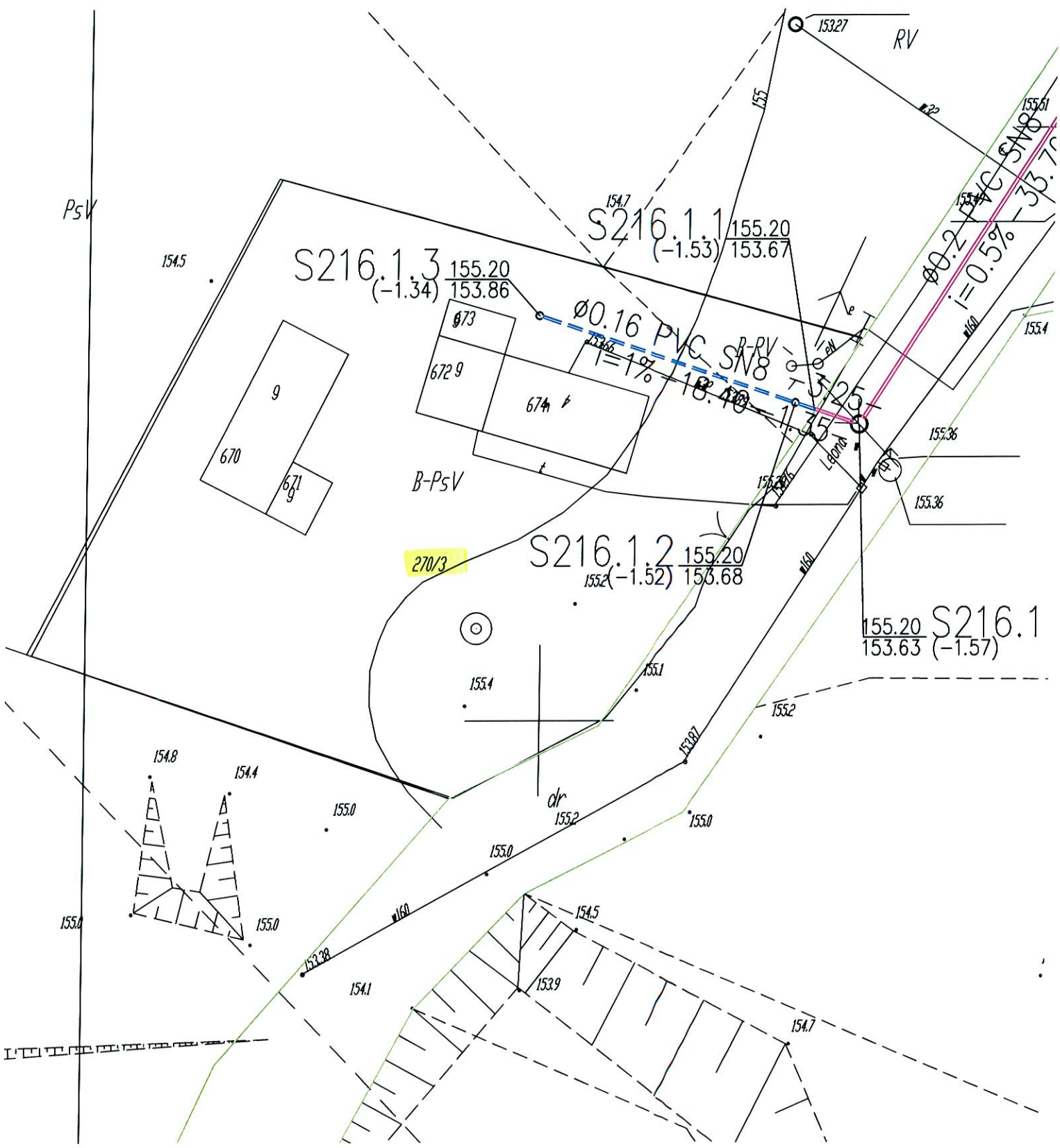

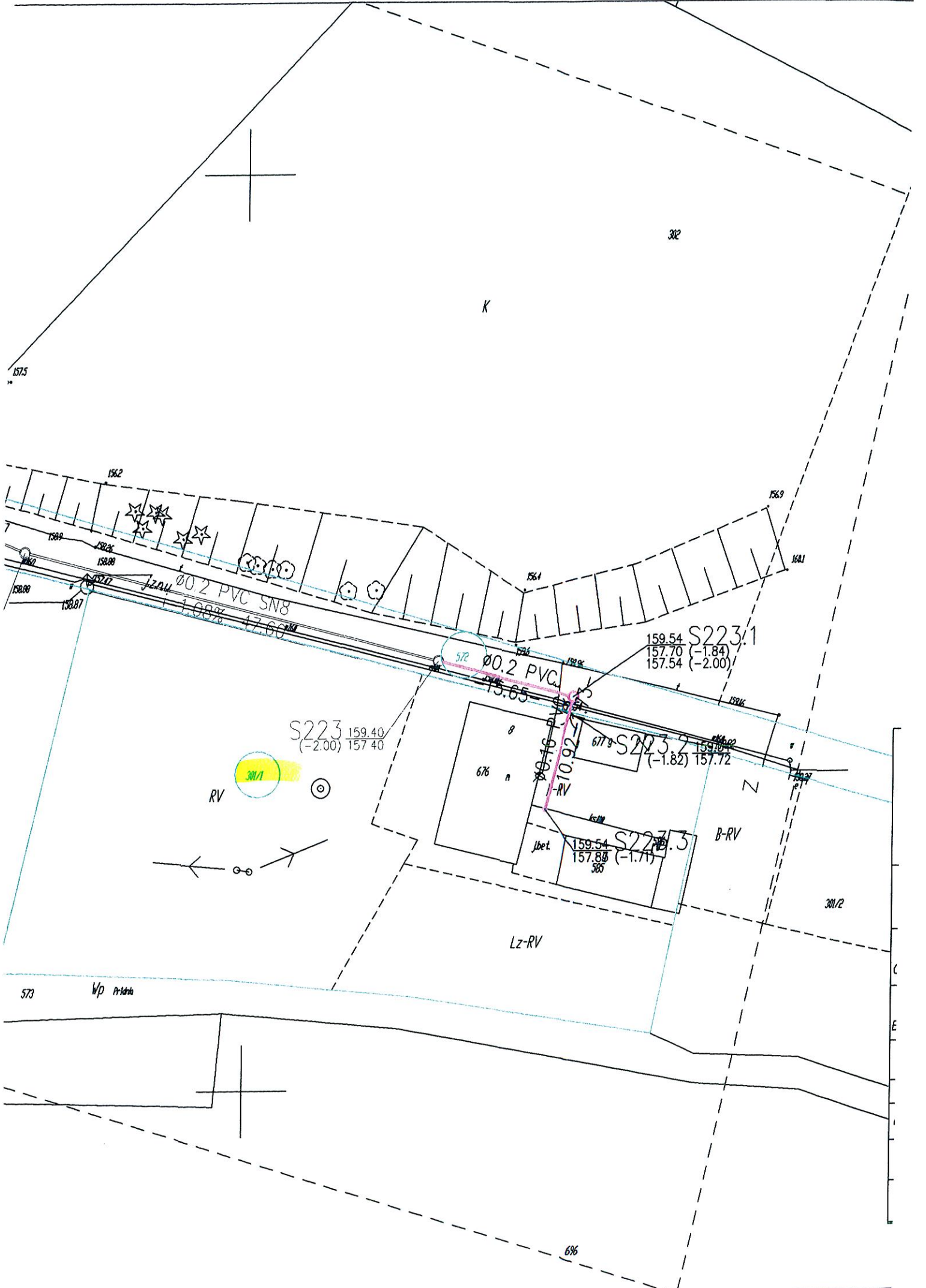

ŁĄCZY RYSUNEK NR 12

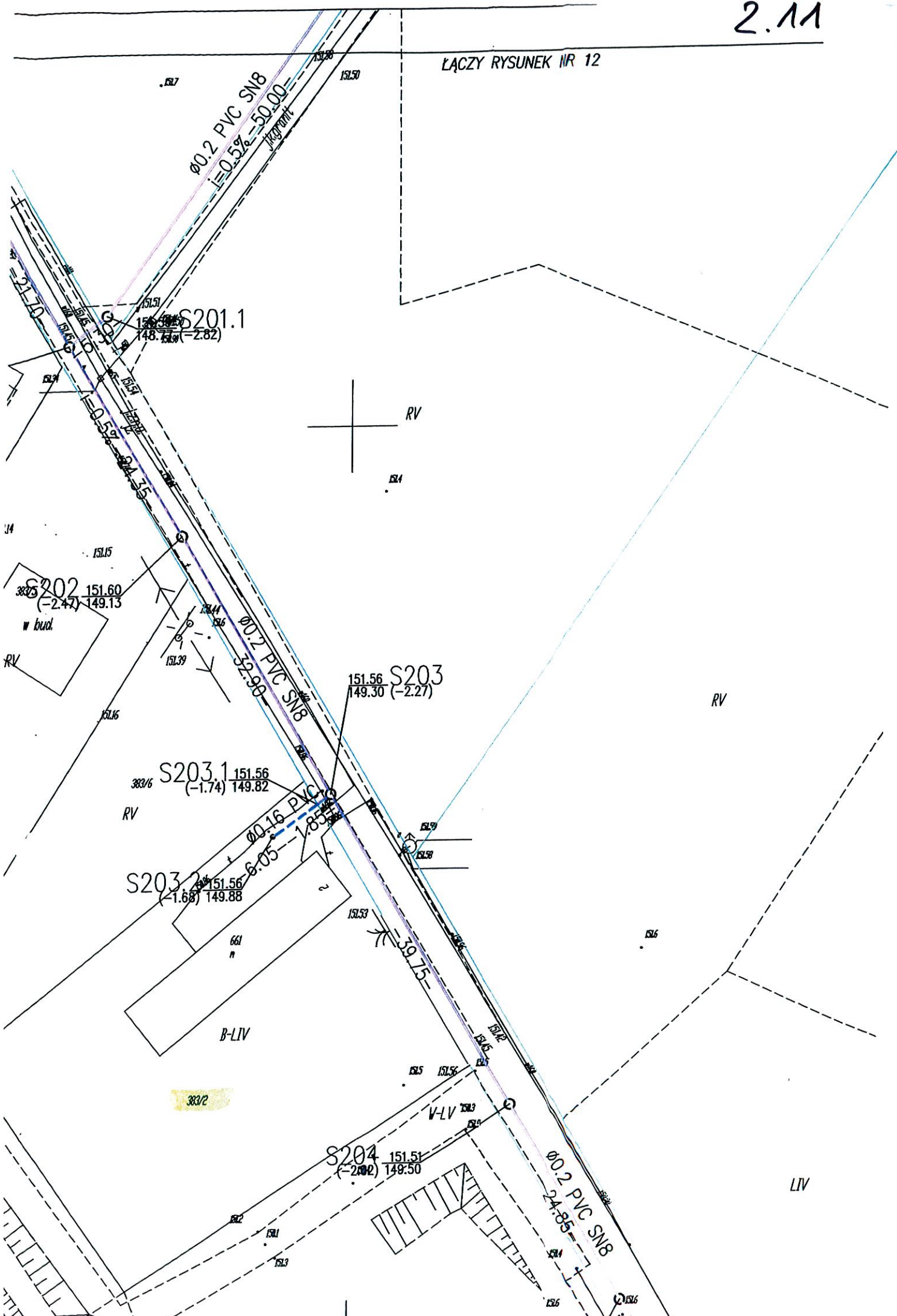

2.12
2.13

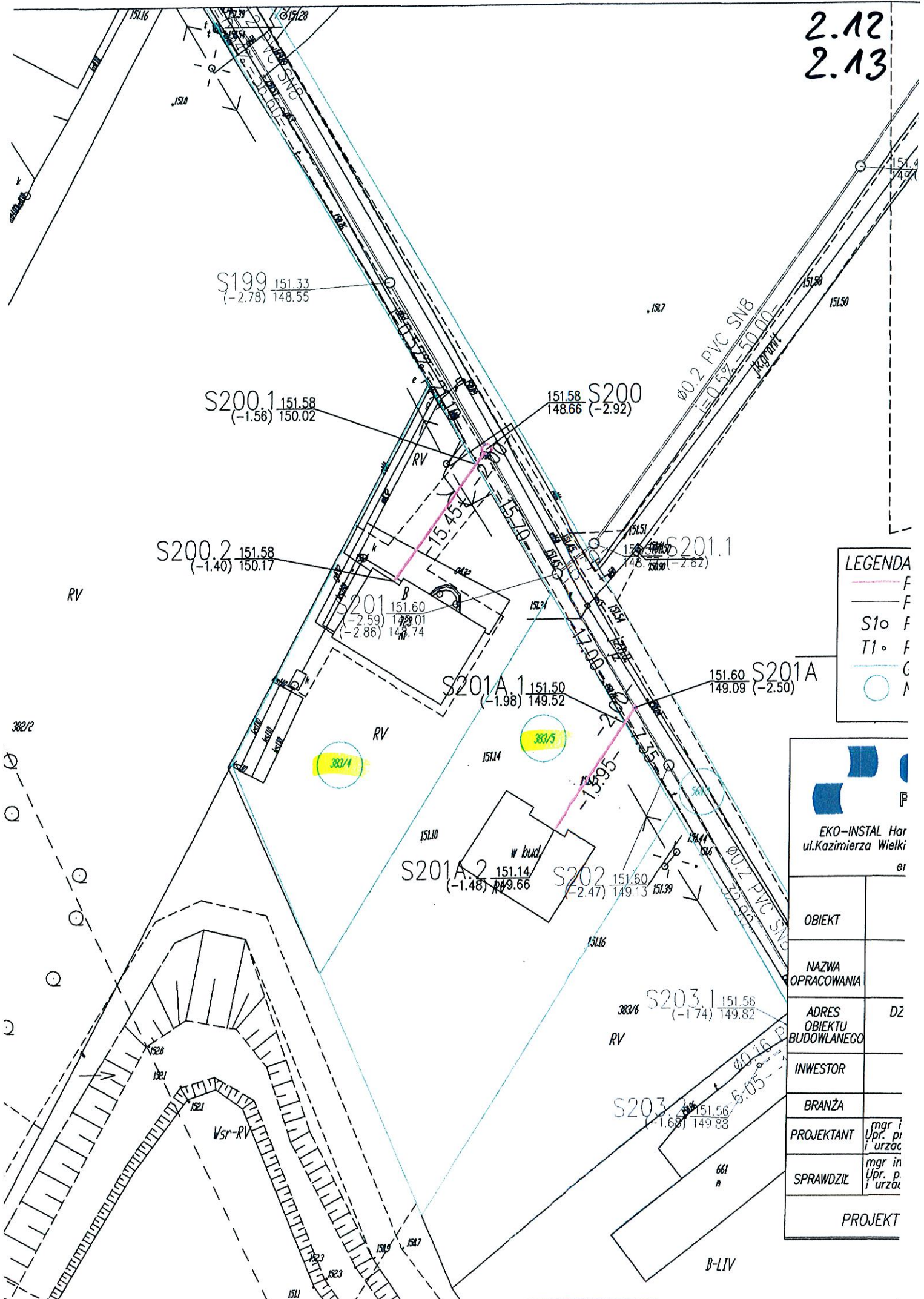

LEGENDA

- F
- F
- S10 F
- T10 F
- C
- M

EKO-INSTAL Har
ul. Kazimierza Wielki
er

OBIEKT	
NAZWA OPRACOWANIA	
ADRES OBIEKTU BUDOWLANEGO	DZ
INWESTOR	
BRANŻA	
PROJEKTANT	mgr i Upr. p i urzad
SPRAWDZIŁ	mgr in Upr. p i urzad
PROJEKT	

- BEŁAJCZ W ZAKRESIE SIARUCCI I ULLJITWILUW
- GRANICE DZIAŁEK OBJĘTYCH WNIOSKIEM
- BEDACE W ZAKRESIE WOJEWODY DOLNOŚLĄSKIEGO
- NUMERY DZIAŁEK OBJĘTYCH WNIOSKIEM
- BEDACE W ZAKRESIE WOJEWODY DOLNOŚLĄSKIEGO
- PROJ. STUDNIA KANALIZACYJNA
- STO PROJ. PRZEPOMPOWNIA ŚCIEKÓW
- PSZ PROJ. PUNKT ZAŁAMANIA KANALIZACJI TŁOCZNEJ
- PZ1 PROJ. PUNKT ZAŁAMANIA KABLA ELEKTRYCZNEGO
- E1

PROJEKTANT	mgr inż. Jacek Sawicki Upř. projekt. w specjaln. instalac. w zakresie sieci, i. urzadz. elektrycznych i energet. nr LUKG/0005/PwE/05			RYŚ.NR	12
SPRAWDZIŁ	mgr inż. Zenon Cybulka Upř. projekt. w specjaln. instalac. w zakresie sieci, inst. urzadz. elektrycznych i energet. nr LUKG/0003/POOE/05			SKALA	1:500
PROJEKT ZAGOSPODAROWANIA TERENU				DATA	16.12.14

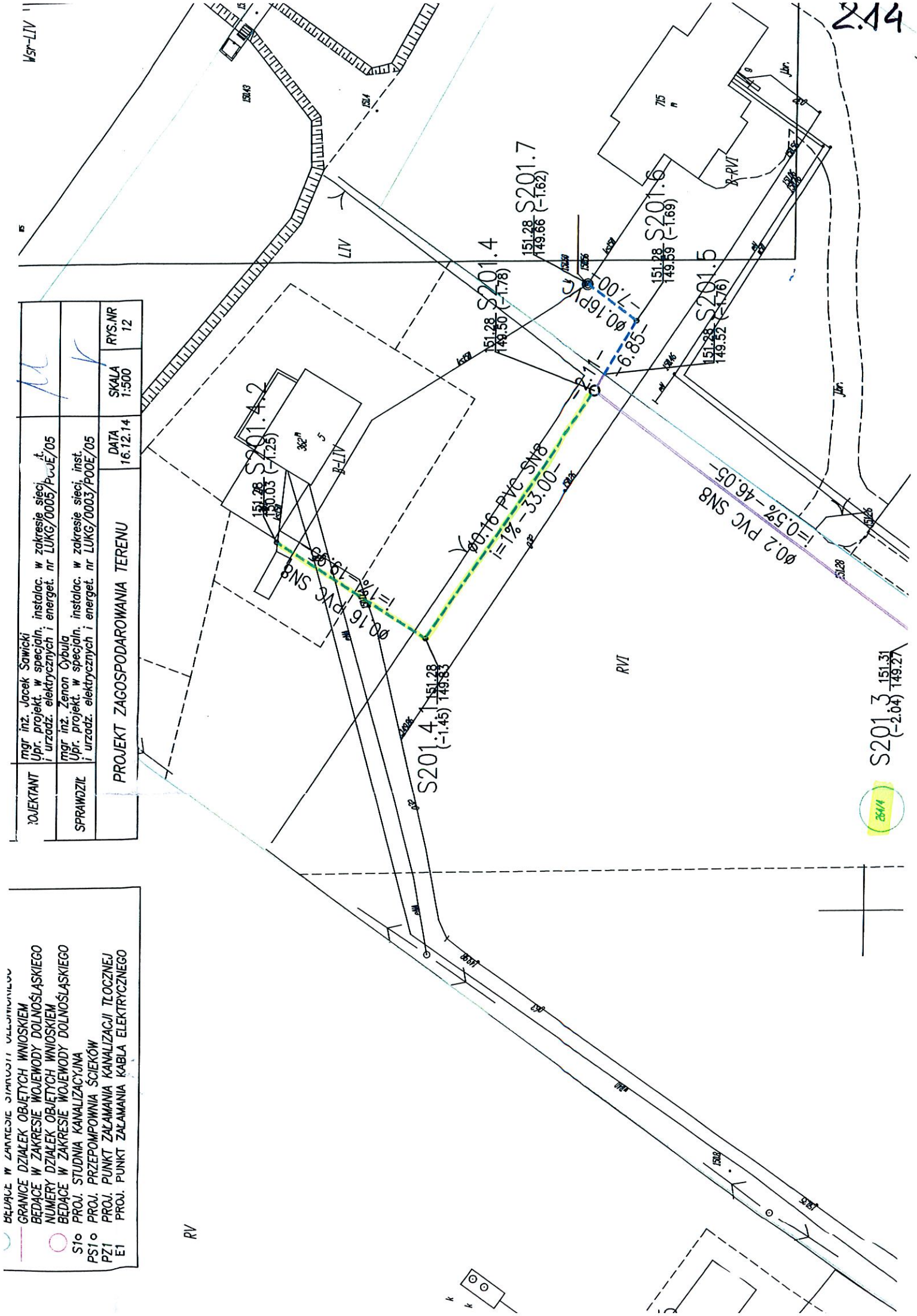

2.44



S201.3 151.31
(-2.04) 149.27

2.15

PsIV

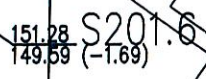
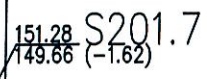
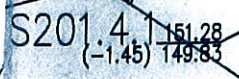

RVI

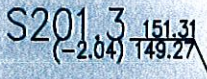
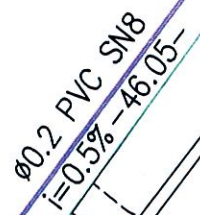

379/1

RV

-50.00-

264/3

201.2
2.43)

RVI

ICZY RYSUNEK NR 16

RV

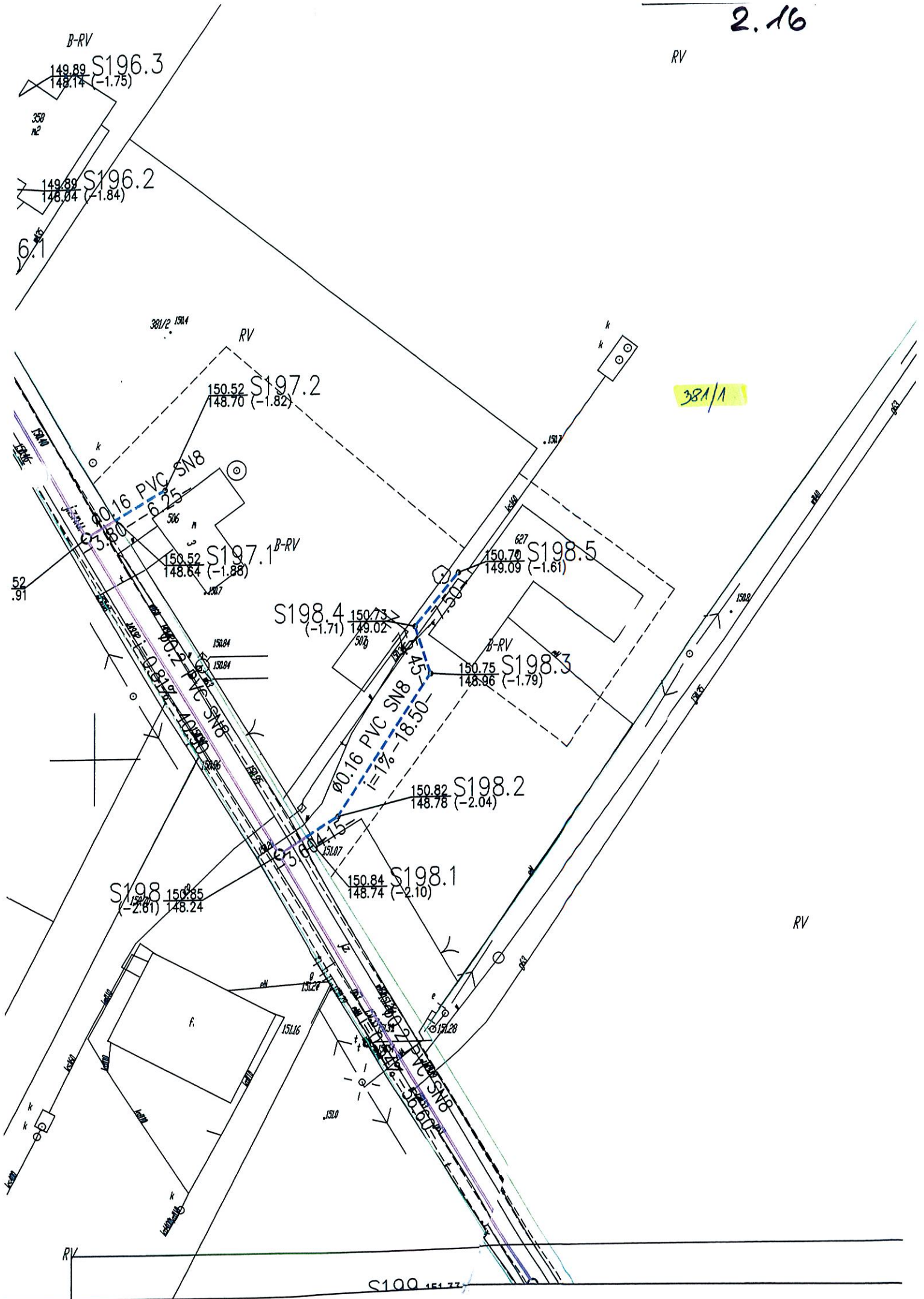

381/1

RV

S199 151.77

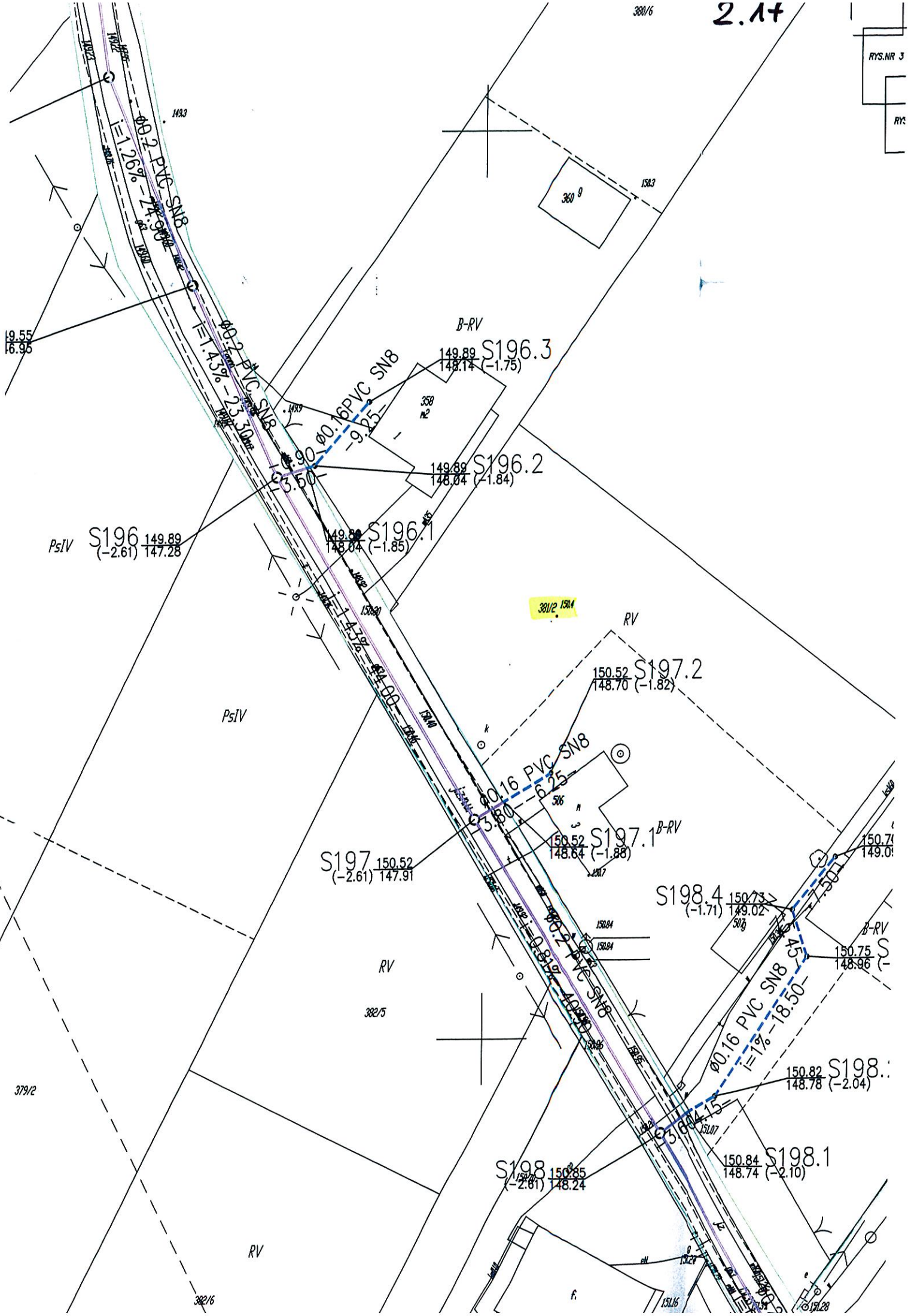

19.55
16.95

381/6

149.3

150.3

B-RV

S196.3
149.89
148.14 (-1.75)

S196.2
149.89
148.04 (-1.84)

PsIV S196
149.89
(-2.61) 147.28

S196.1
149.89
148.04 (-1.85)

381/2 150.4

RV

S197.2
150.52
148.70 (-1.82)

PsIV

S197
150.52
(-2.61) 147.91

S197.1
150.52
148.64 (-1.88)

S198.4
150.73
(-1.71) 149.02

RV

150.74
149.01

150.75
148.96 (-)

379/2

382/5

S198.1
150.82
148.78 (-2.04)

S198
150.85
(-2.61) 148.24

S198.1
150.84
148.74 (-2.10)

RV

382/6

f.

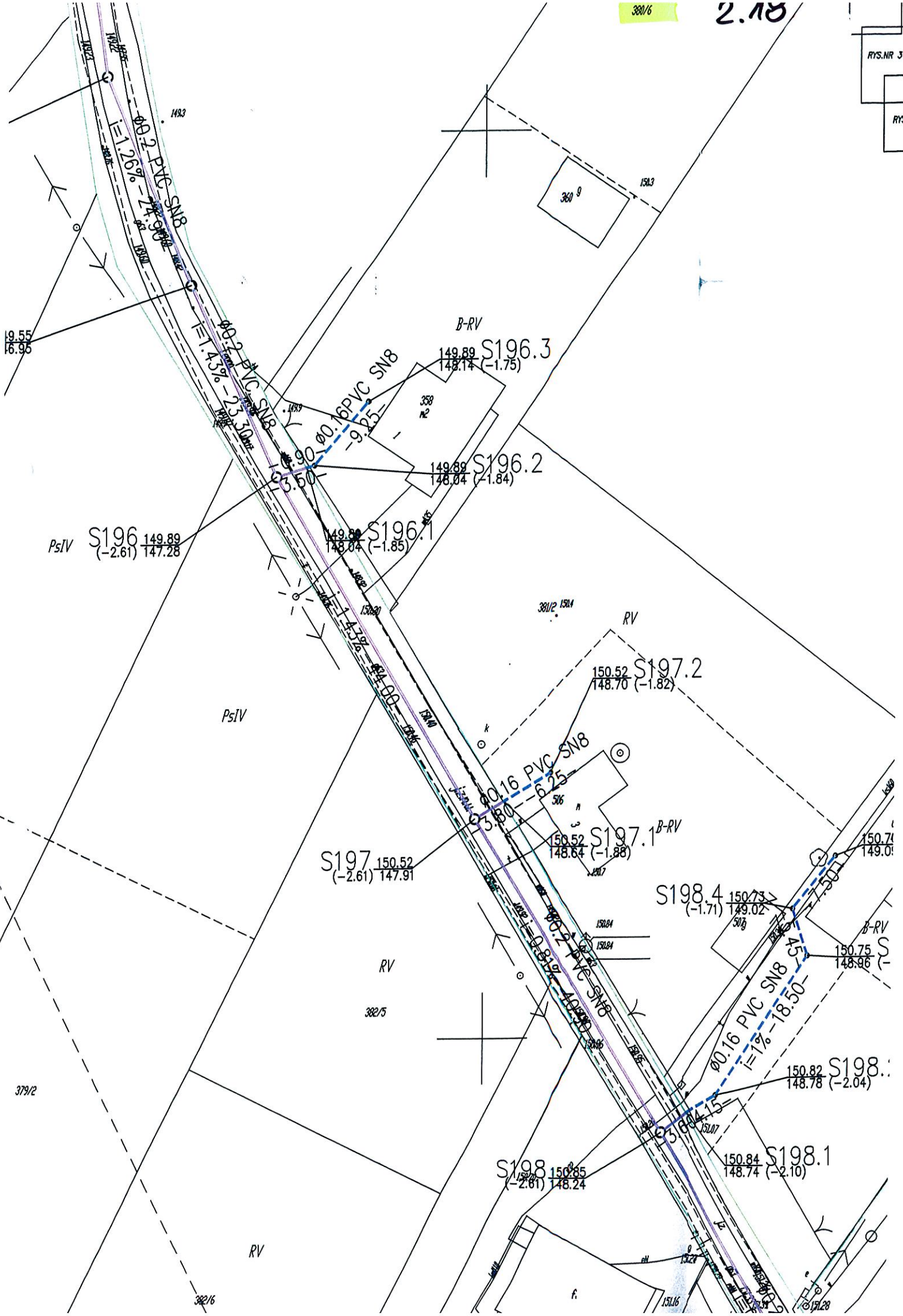

2.19

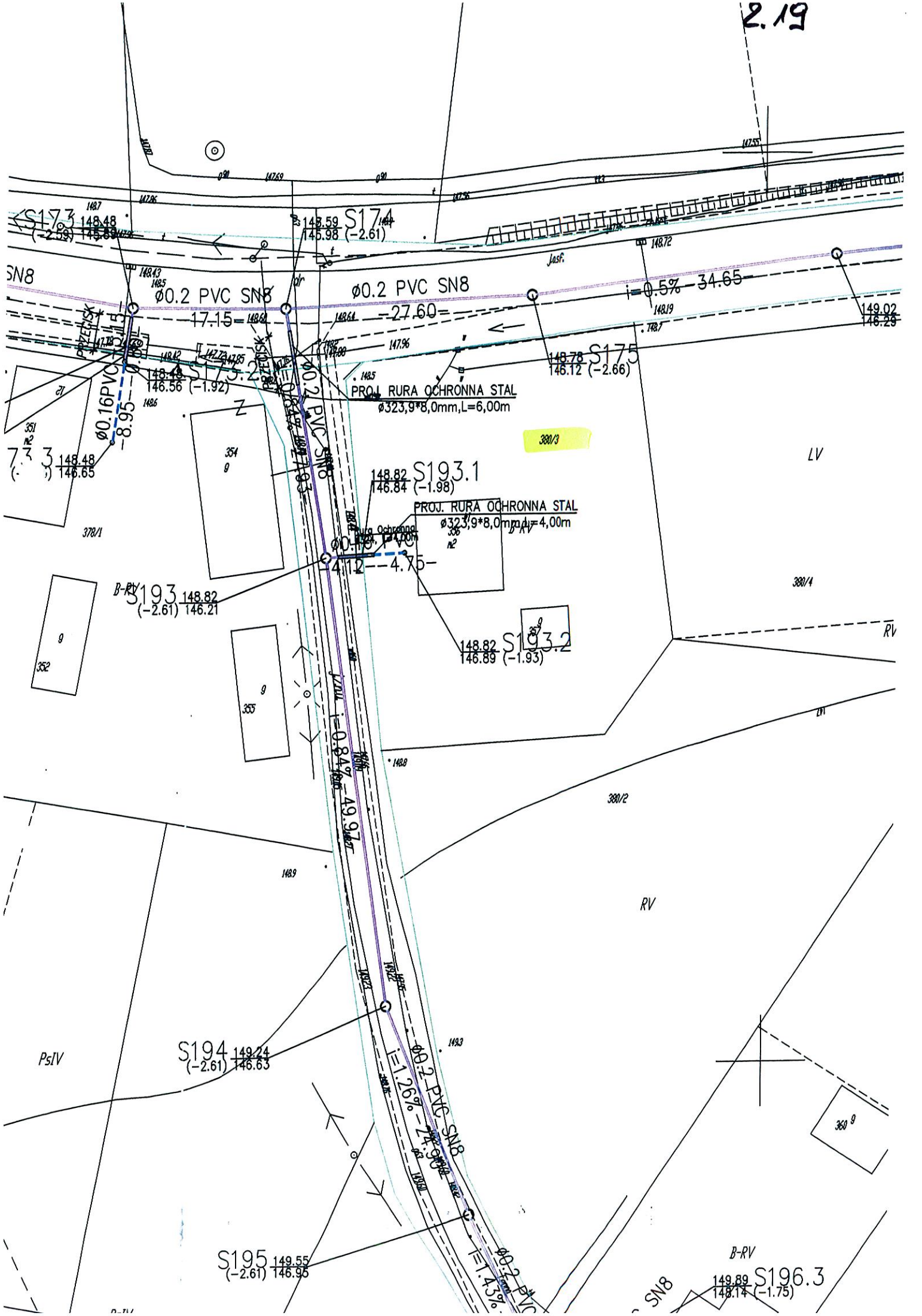

S173 148.48
(-2.61) 145.89

S174 148.59
(-2.61) 145.98

Ø0.2 PVC SN8
i=0.5% 34.65

SN8
Ø0.2 PVC SN8
17.15

Ø0.2 PVC SN8
-27.60

Ø0.16 PVC
-8.95

PROJ. RURA OCHRONNA STAL
Ø323,9*8,0mm, L=6,00m

S175 148.78
(-2.66) 146.12

351
148.48
(-2.61) 146.65

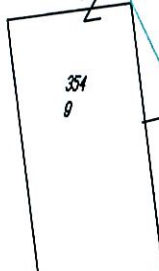

S193.1 148.82
(-1.98) 146.84

PROJ. RURA OCHRONNA STAL
Ø323,9*8,0mm, L=4,00m

B-RV
S193 148.82
(-2.61) 146.21

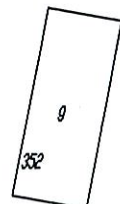

S193.2 148.82
(-1.93) 146.89

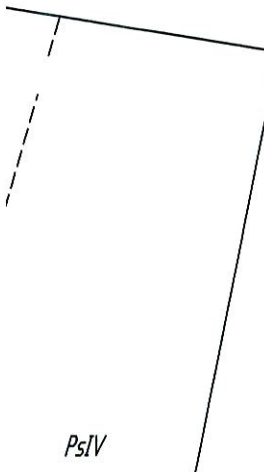

S194 149.24
(-2.61) 146.63

S195 149.55
(-2.61) 146.95

B-RV
S196.3 149.89
(-1.75) 148.14



378/1

B-RV 193 148.82
(-2.61) 146.21

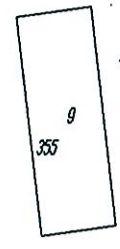
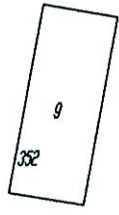

148.1
146.7

RIVb

Ø1

1489

S194.3 149.10
(+1.26) 147.84

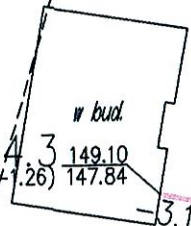

S194.1 149.22
(-1.69) 147.54

Ø0.16 PVC SN8
i=1% -27.05-

S194.2 149.11
(-1.31) 147.81
PsIV

S194 149.24
(-2.61) 146.63



S195 149.55
(-2.61) 146.95

RV

PsIV

1481



PsIV S196 149.89
(-2.61) 147.28

