

1.1
1.2

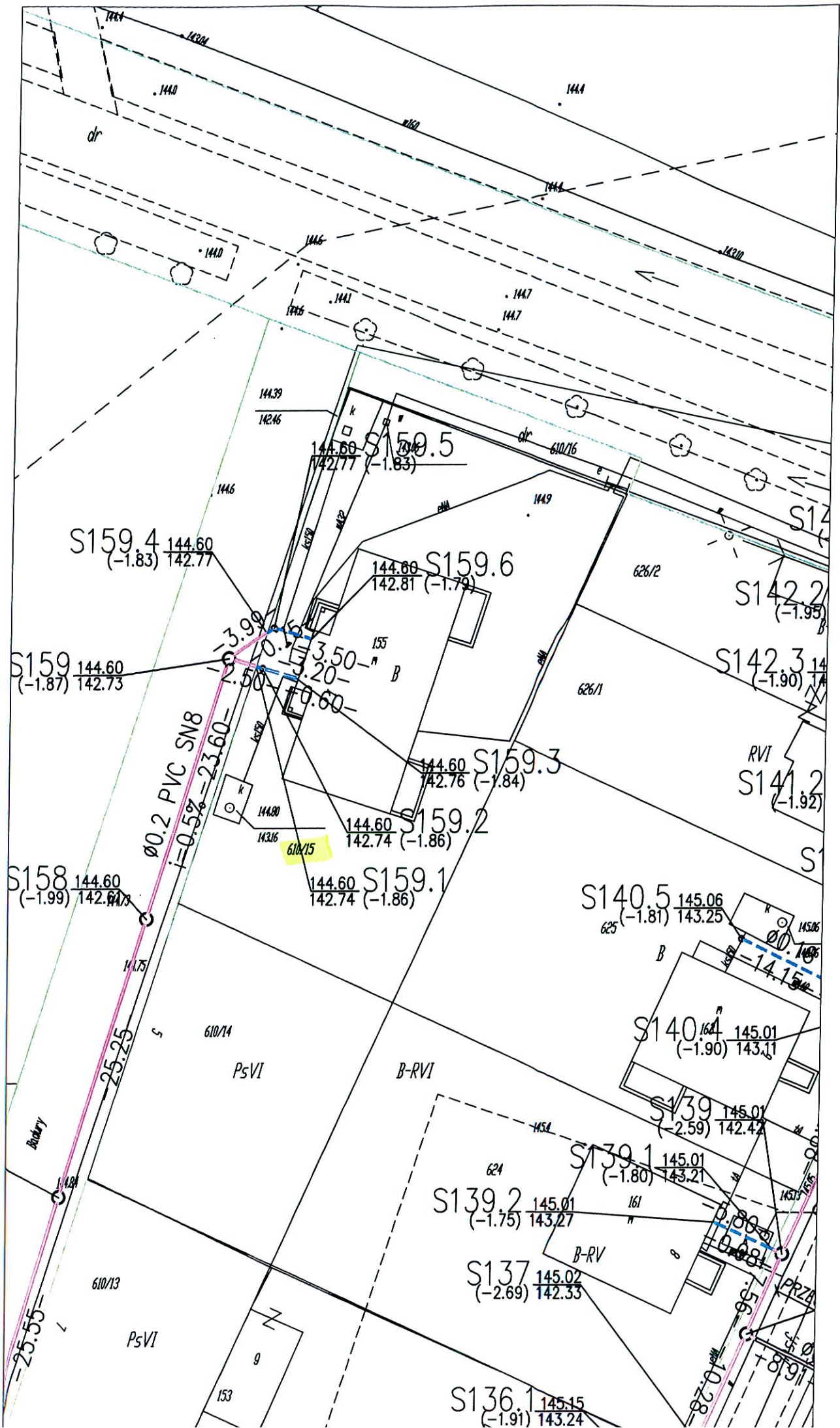

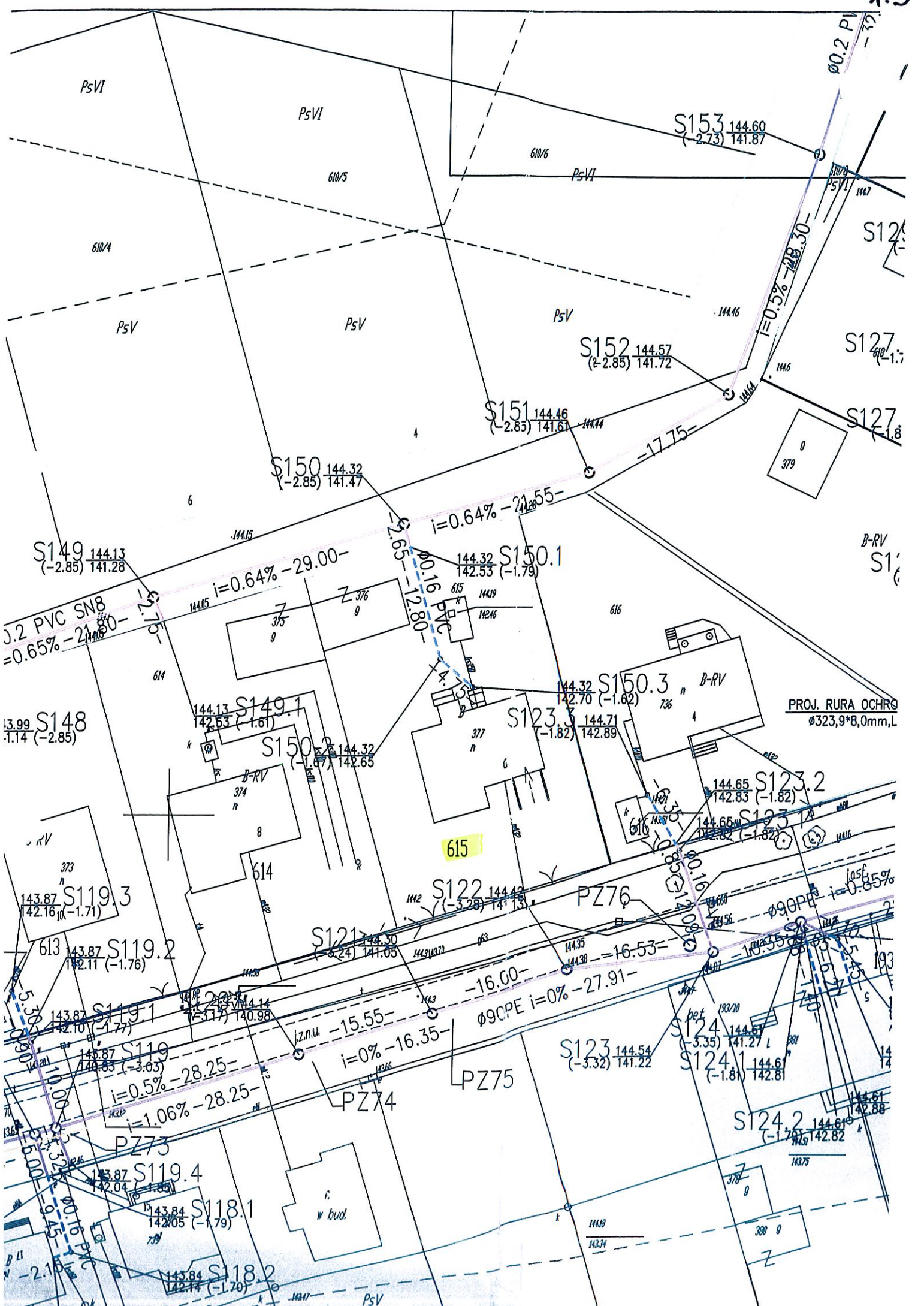

1.3

PsVI

PsVI

S153 144.60
(-2.73) 141.87

610/4

PsV

PsV

PsV

S152 144.57
(-2.85) 141.72

S127

S127

S127

S151 144.46
(-2.85) 141.61

S150 144.32
(-2.85) 141.47

S149 144.13
(-2.85) 141.28

S150.1 144.32
142.53 (-1.79)

0.2 PVC SN8
=0.65% -21.80-

i=0.64% -29.00-

i=0.64% -21.55-

S148 143.99
141.14 (-2.85)

S149.1 144.13
142.53 (-1.61)

S123.3 144.71
(-1.82) 142.89

PROJ. RURA OCHRO
Ø323,9*8,0mm,L

S150.3 144.32
142.70 (-1.62)

S123.2 144.65
142.83 (-1.82)

S123.1 144.65
142.83 (-1.82)

S119.3 143.87
142.16 (-1.71)

S150.2 144.32
(-1.67) 142.65

S122 144.42
(-3.28) 141.14

PZ76

i=0.85%

S119.2 143.87
142.11 (-1.76)

S121 144.30
(-3.24) 141.06

-16.00-

-16.55-

-16.55-

S119.1 143.87
142.10 (-1.77)

S119 143.87
142.05 (-1.82)

S119.4 143.87
142.04 (-1.83)

S118.1 143.84
142.05 (-1.79)

S118.2 143.84
142.14 (-1.70)

S118.3 143.84
142.14 (-1.70)

i=0.5% -28.25-

i=1.06% -28.25-

i=0% -16.35-

i=0% -27.91-

S123 144.54
(-3.32) 141.22

S124 144.67
(-3.35) 141.32

S124.1 144.67
(-1.81) 142.86

S124.2 144.67
(-1.75) 142.92

PZ74

PZ75

PsV

300 g

Z

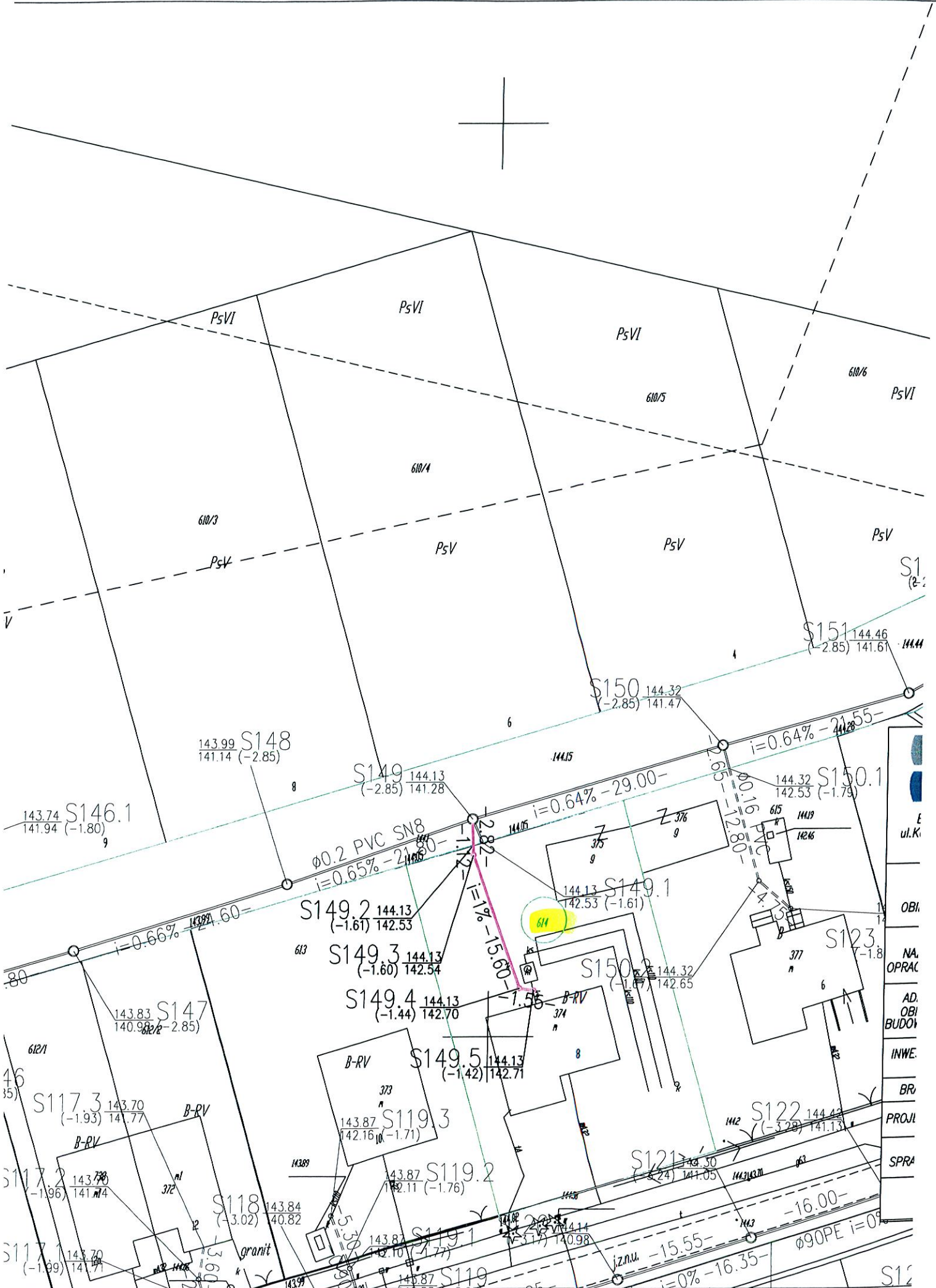

	E ul.K.
	OB
	NA. OPRAC
	AD. OBI BUDO
	INWE.
	BR
	PROJL
	SPRA
	S12

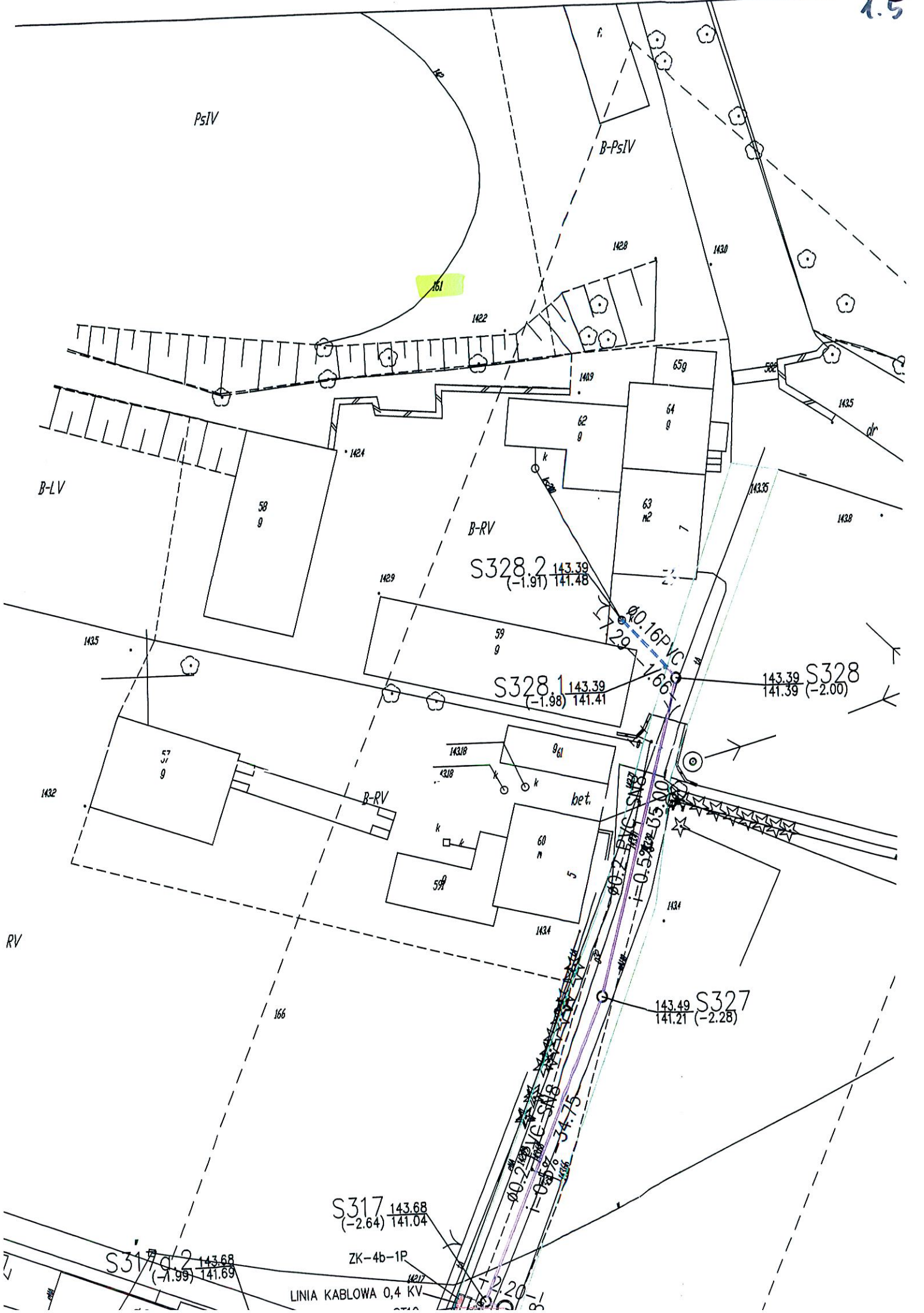

PsIV

B-PsIV

161

B-LV

58
g

B-RV

S328.2 143.39
(-1.91) 141.48

S328.1 143.39
(-1.98) 141.41

S328 143.39
(-2.00) 141.39

57
g

B-RV

961

60
m

bet.

59g

RV

166

S327 143.49
(-2.28) 141.21

S317 143.68
(-2.64) 141.04

ZK-4b-1P

LINIA KABLOWA 0,4 KV

S317 d.2 143.68
(-1.99) 141.69

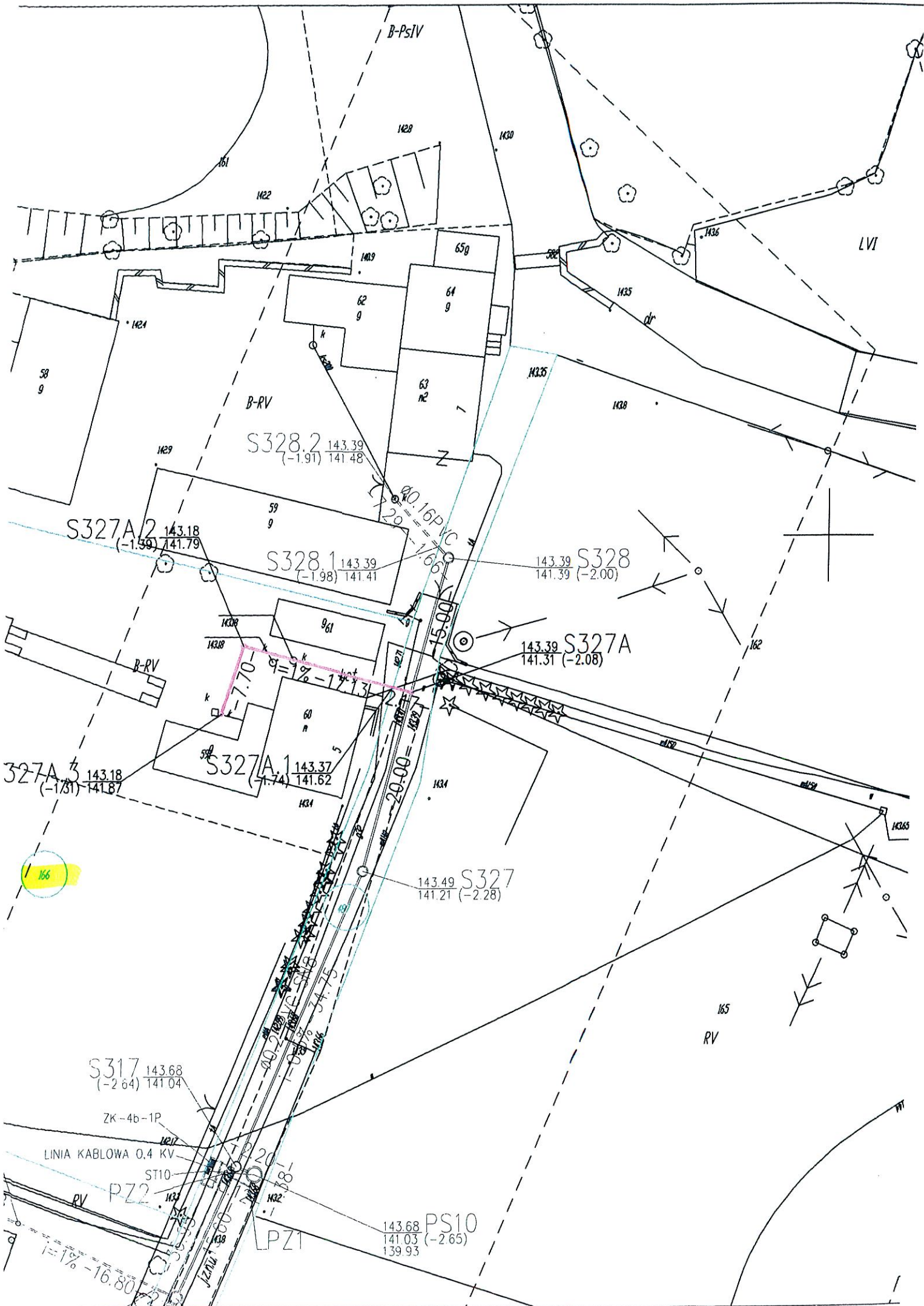

166

165
RV

LVI

B-PsIV

B-RV

B-RV

S317 143.68
(-2.64) 141.04

LINIA KABLOWA 0.4 KV

ST10

PZ2

RV

PS10 143.68
141.03 (-2.65)
139.93

LPZ1

143.39 S327A
141.31 (-2.08)

143.39 S328
141.39 (-2.00)

S328.1 143.39
(-1.98) 141.41

S328.2 143.39
(-1.91) 141.48

S327A.2 143.18
(-1.99) 141.79

S327A.3 143.18
(-1.81) 141.87

S327A.1 143.37
(-1.74) 141.62

143.49 S327
141.21 (-2.28)

$i=1\% -16.80$

20:00

15:00

10:16p

20

10:16p

10:16p

10:16p

10:16p

10:16p

10:16p

10:16p

10:16p

10:16p

10:16p

10:16p

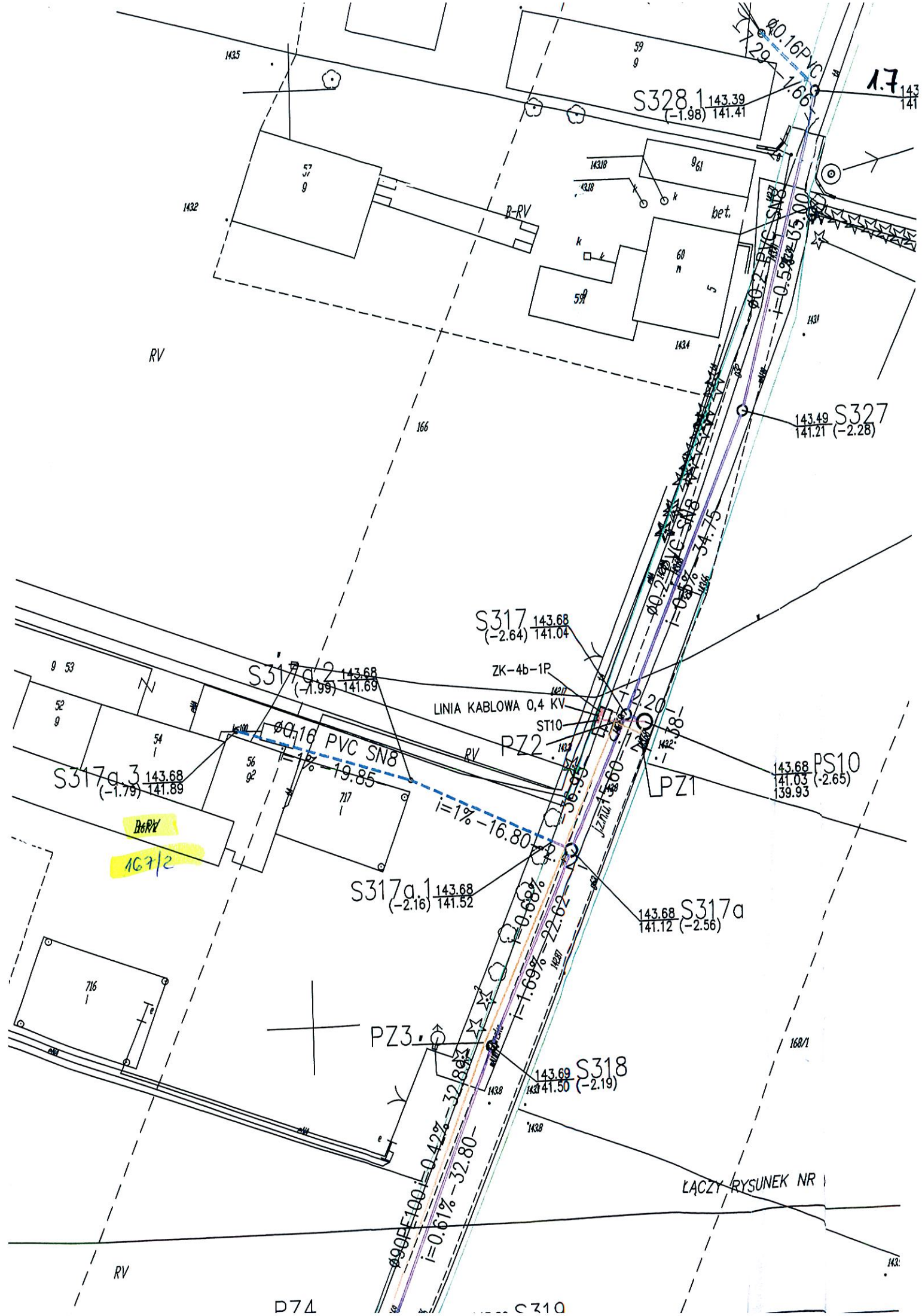

LACZY RYSUNEK NR 1

D74

S310

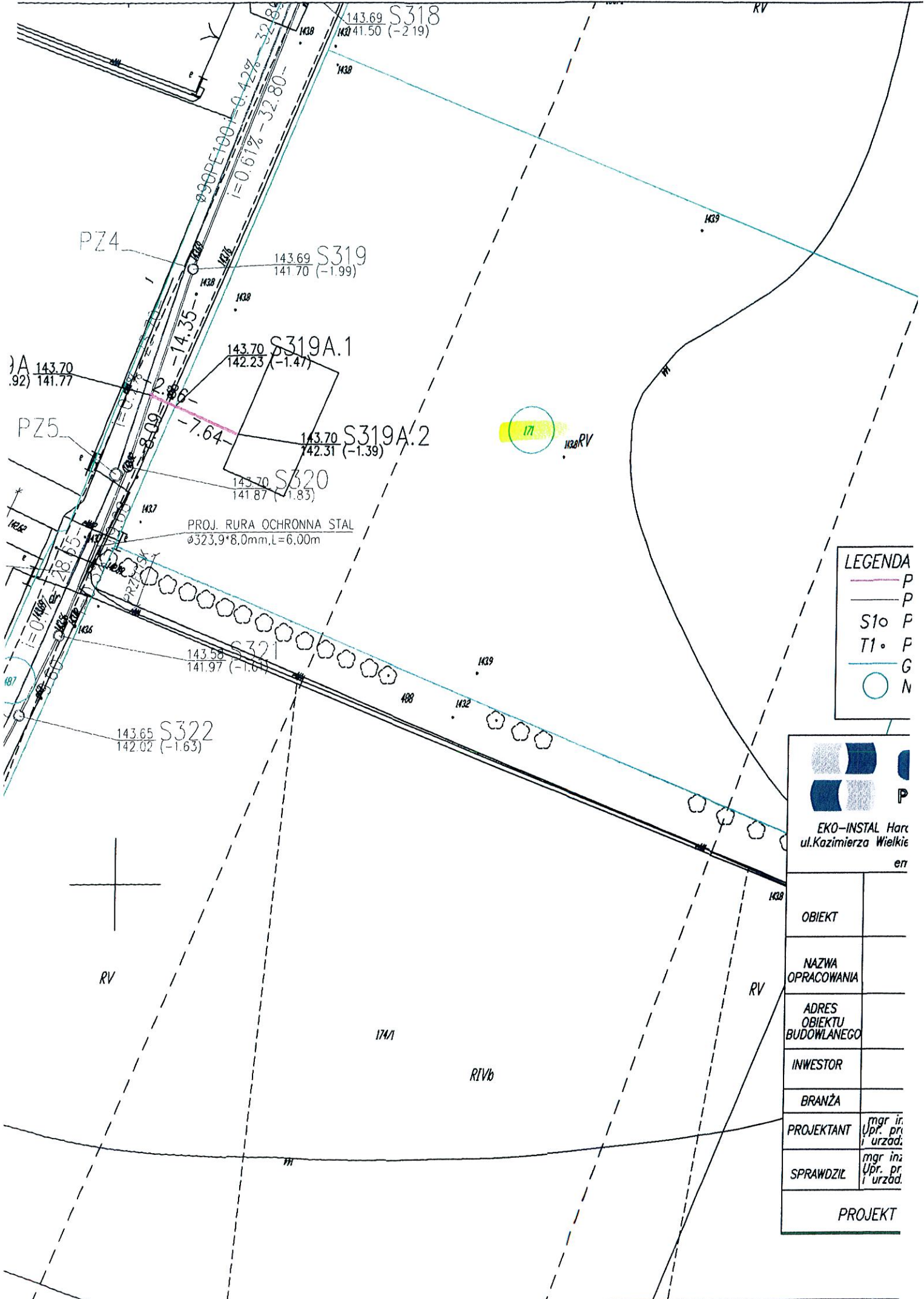

LEGENDA

- P
- P
- S10 P
- T1 P
- G
- N

EKO-INSTAL Harc
 ul. Kazimierza Wielkiego
 00-000-000

OBIEKT	
NAZWA OPRACOWANIA	
ADRES OBIEKTU BUDOWLANEGO	
INWESTOR	
BRANŻA	
PROJEKTANT	mgr inż. Upr. pr. i urz.
SPRAWDZIŁ	mgr inż. Upr. pr. i urz.
PROJEKT	

PROJEKTANT	Upr. projekt. w specjln. instalac. w zakresie sieci, inst. i urzadz. elektrycznych i energet. nr LUKG/0005/POOE/05			
SPRAWDZIL	n.gr inż. Zenon Cybula Upr. projekt. w specjln. instalac. w zakresie sieci, inst. i urzadz. elektrycznych i energet. nr LUKG/0003/POOE/05			
PROJEKT ZAGOSPODAROWANIA TERENU		DATA	SKALA	RYS.NR
		16.12.14	1:500	9



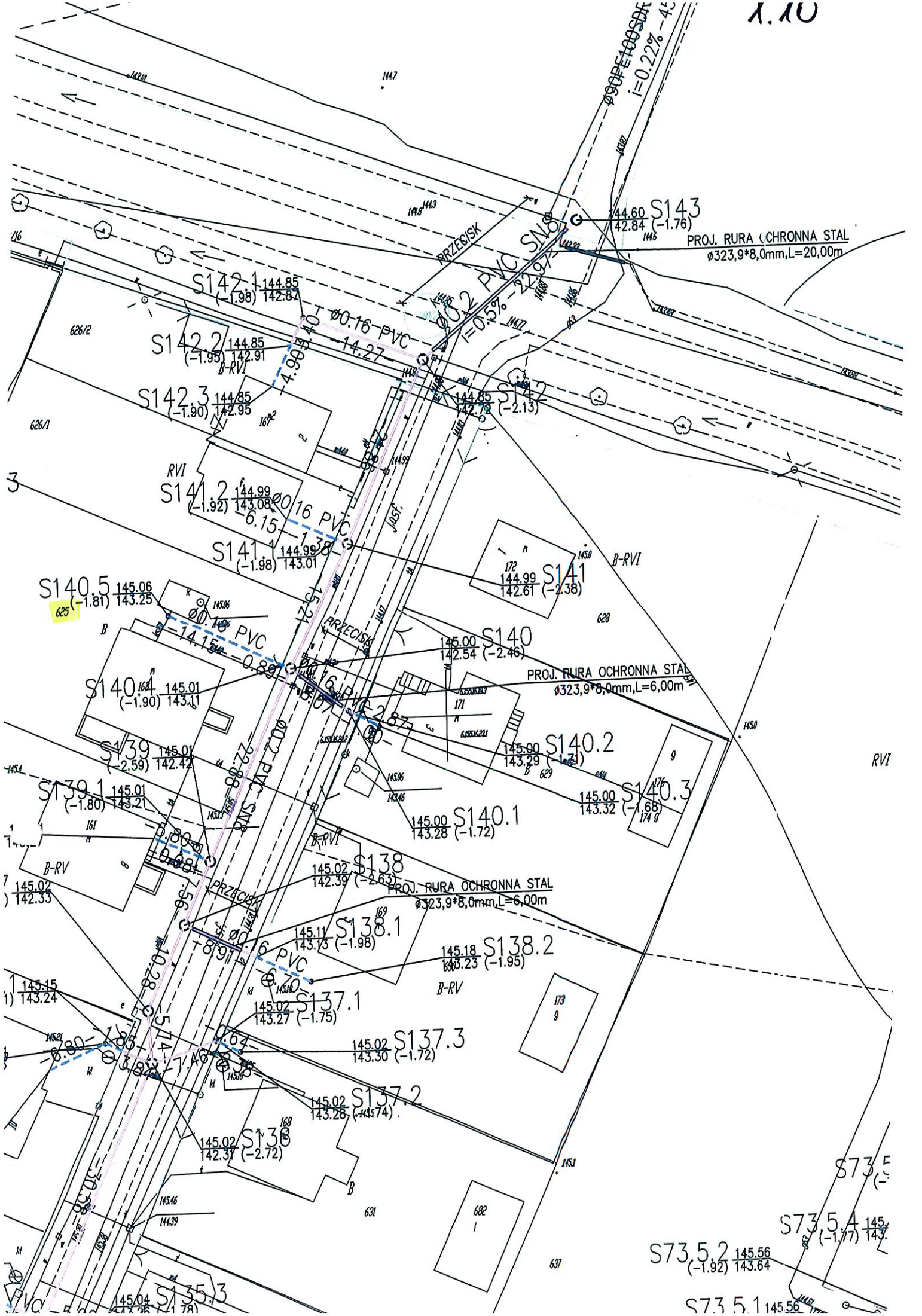

PROJ. RURA (CHRONNA STAL
 ø323,9*8,0mm,L=20,00m

PROJ. RURA OCHRONNA STAL
 ø323,9*8,0mm,L=6,00m

PROJ. RURA OCHRONNA STAL
 ø323,9*8,0mm,L=6,00m

S73.5.4 145.56
 (-1.77) 143.79

S73.5.2 145.56
 (-1.92) 143.64

S73.5.1 145.56

S140.5 145.06
 (-1.81) 143.25

S140.164 145.01
 (-1.90) 143.11

S139.1 145.01
 (-1.80) 143.21

S139.1 145.01
 (-1.80) 143.21

S139.1 145.01
 (-1.80) 143.21

S139.1 145.01
 (-1.80) 143.21

S139.1 145.01
 (-1.80) 143.21

S139.1 145.01
 (-1.80) 143.21

S139.1 145.01
 (-1.80) 143.21

S139.1 145.01
 (-1.80) 143.21

S139.1 145.01
 (-1.80) 143.21

S139.1 145.01
 (-1.80) 143.21

S142.1 144.85
 (-1.98) 142.87

S142.2 144.85
 (-1.98) 142.91

S142.3 144.85
 (-1.90) 142.95

S141.2 144.99
 (-1.92) 143.08

S141.1 144.99
 (-1.98) 143.01

S140.5 145.06
 (-1.81) 143.25

S140.164 145.01
 (-1.90) 143.11

S139.1 145.01
 (-1.80) 143.21

S139.1 145.01
 (-1.80) 143.21

S139.1 145.01
 (-1.80) 143.21

S139.1 145.01
 (-1.80) 143.21

S139.1 145.01
 (-1.80) 143.21

S139.1 145.01
 (-1.80) 143.21

S139.1 145.01
 (-1.80) 143.21

S139.1 145.01
 (-1.80) 143.21

S139.1 145.01
 (-1.80) 143.21

S139.1 145.01
 (-1.80) 143.21

S139.1 145.01
 (-1.80) 143.21

S141.172 144.99
 (-2.38) 142.61

S140.171 145.00
 (-2.46) 142.54

S140.2 145.00
 (-1.68) 143.32

S140.3 145.00
 (-1.68) 143.32

S140.1 145.00
 (-1.72) 143.28

S138.169 145.02
 (-2.63) 142.39

S138.2 145.18
 (-1.95) 143.23

S137.1 145.02
 (-1.75) 143.27

S137.3 145.02
 (-1.72) 143.30

S137.2 145.02
 (-1.74) 143.28

S136.168 145.02
 (-2.72) 142.30

S135.3 145.04
 (-1.78) 143.26

S135.3 145.04
 (-1.78) 143.26

PROJ. RURA OCHRONNA STAL
ø323,9*8,0mm,L=8,0m

PROJ. RURA OCHRONNA STAL
ø323,9*8,0mm,L=7,50m

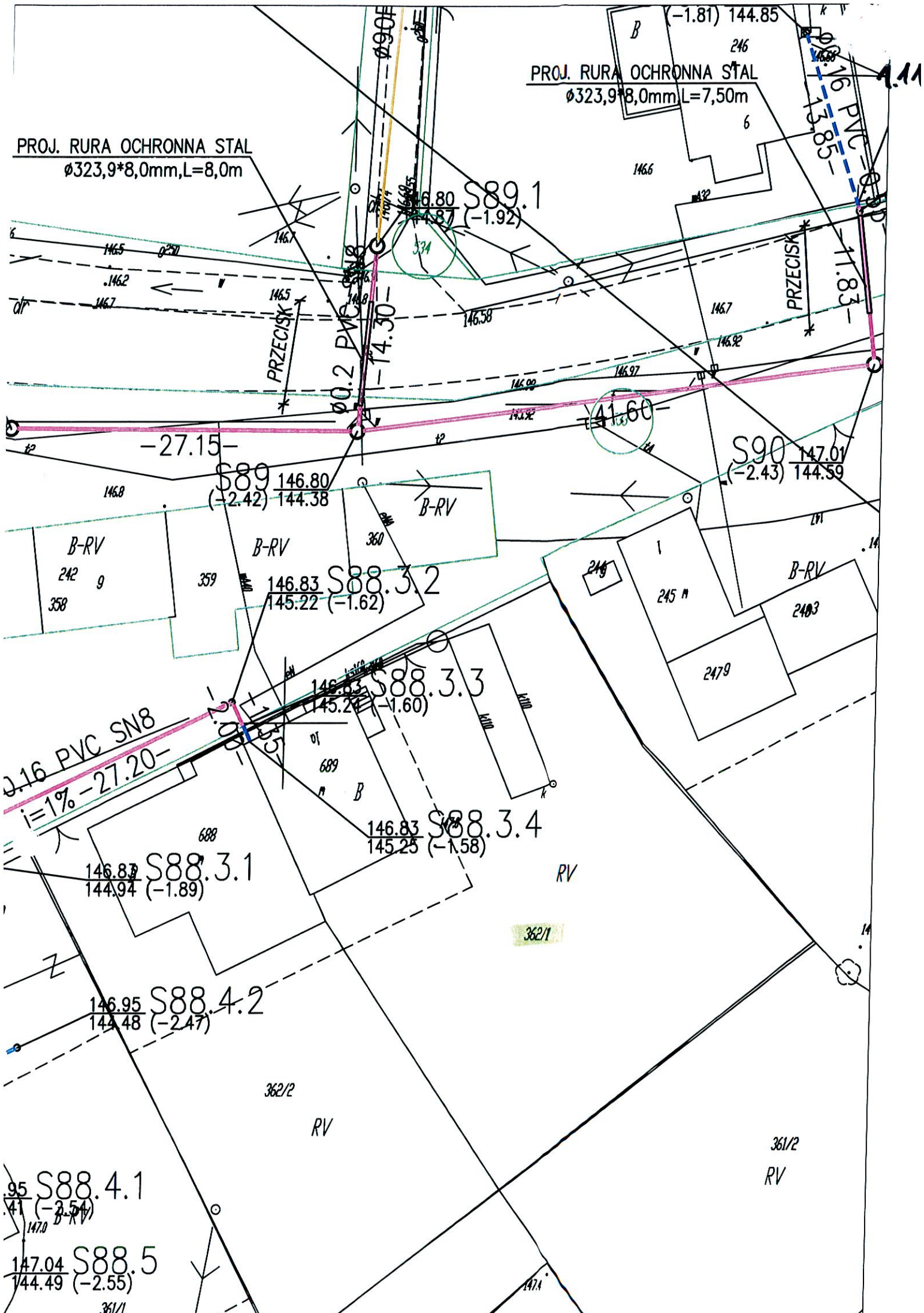

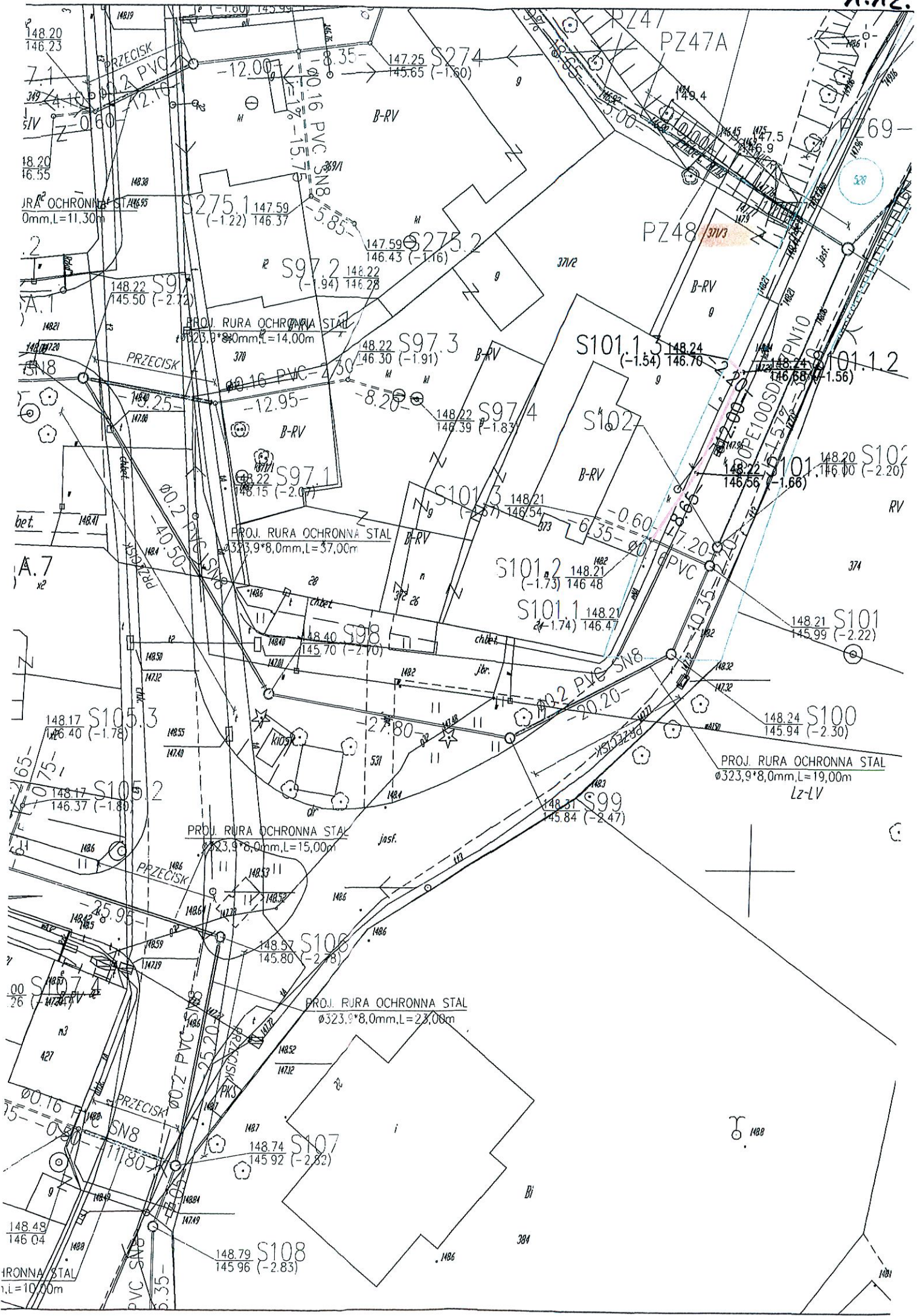

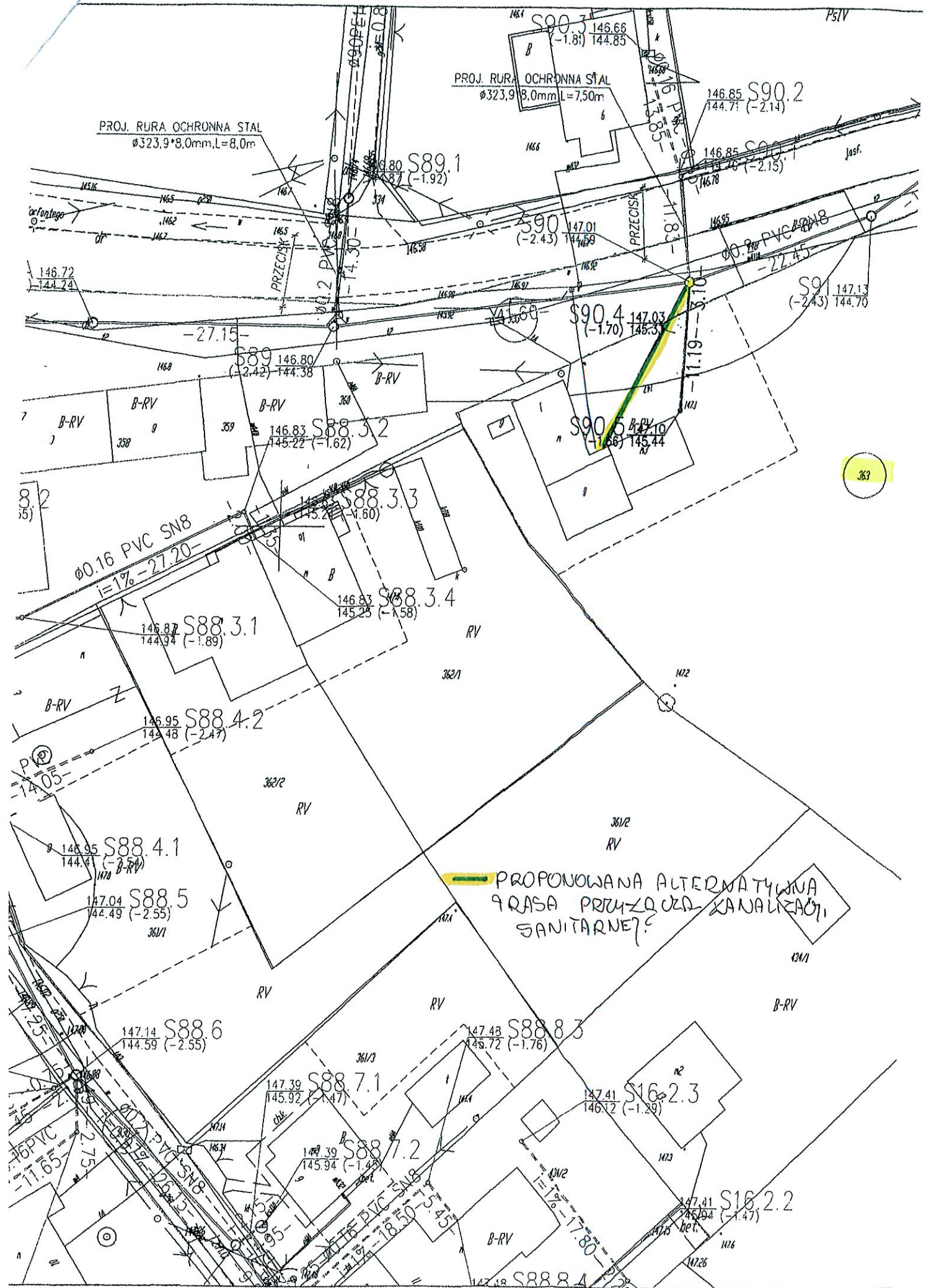

PROPONOWANA ALTERNATYWNA
PRASA PRZYŁOŻENIA KANALIZACJI
SANITARNEJ

363

P5/IV

PROJ. RURA OCHRONNA STAL
Ø323.9*8.0mm L=7,50m

PROJ. RURA OCHRONNA STAL
Ø323.9*8.0mm, L=8,0m

Ø0.16 PVC SN8
i=1%=-27.20

S16.2.3
147.41 / 146.12 (-1.29)

S16.2.2
147.41 / 145.94 (-1.47)

S88.6
147.14 / 144.59 (-2.55)

S88.8.3
147.43 / 145.72 (-1.76)

S88.4.1
146.95 / 144.41 (-2.54)

S88.4.2
146.95 / 144.48 (-2.47)

S88.3.1
146.87 / 144.94 (-1.89)

S88.3.4
146.83 / 145.25 (-1.58)

S88.3.3
145.80 / 145.22 (-1.60)

S88.3.2
146.83 / 145.22 (-1.62)

S90.5
147.03 / 145.44 (-1.59)

S90.4
147.03 / 145.37 (-1.70)

S90.1
147.13 / 144.70 (-2.43)

S90.2
147.01 / 144.59 (-2.43)

S90.2
146.85 / 144.71 (-2.14)

S90.1
146.85 / 146.78 (-2.15)

S89.1
146.80 / 145.87 (-1.92)

S90.3
146.66 / 144.85 (-1.81)

146.72 / 144.24

Ø16 PVC
i=1.65

S88.7.1
147.39 / 145.92 (-1.47)

S88.7.2
147.39 / 145.94 (-1.45)

S88.8.4
147.48 / 145.88 (-1.60)

S16.2.1
147.41 / 146.15 (-1.26)

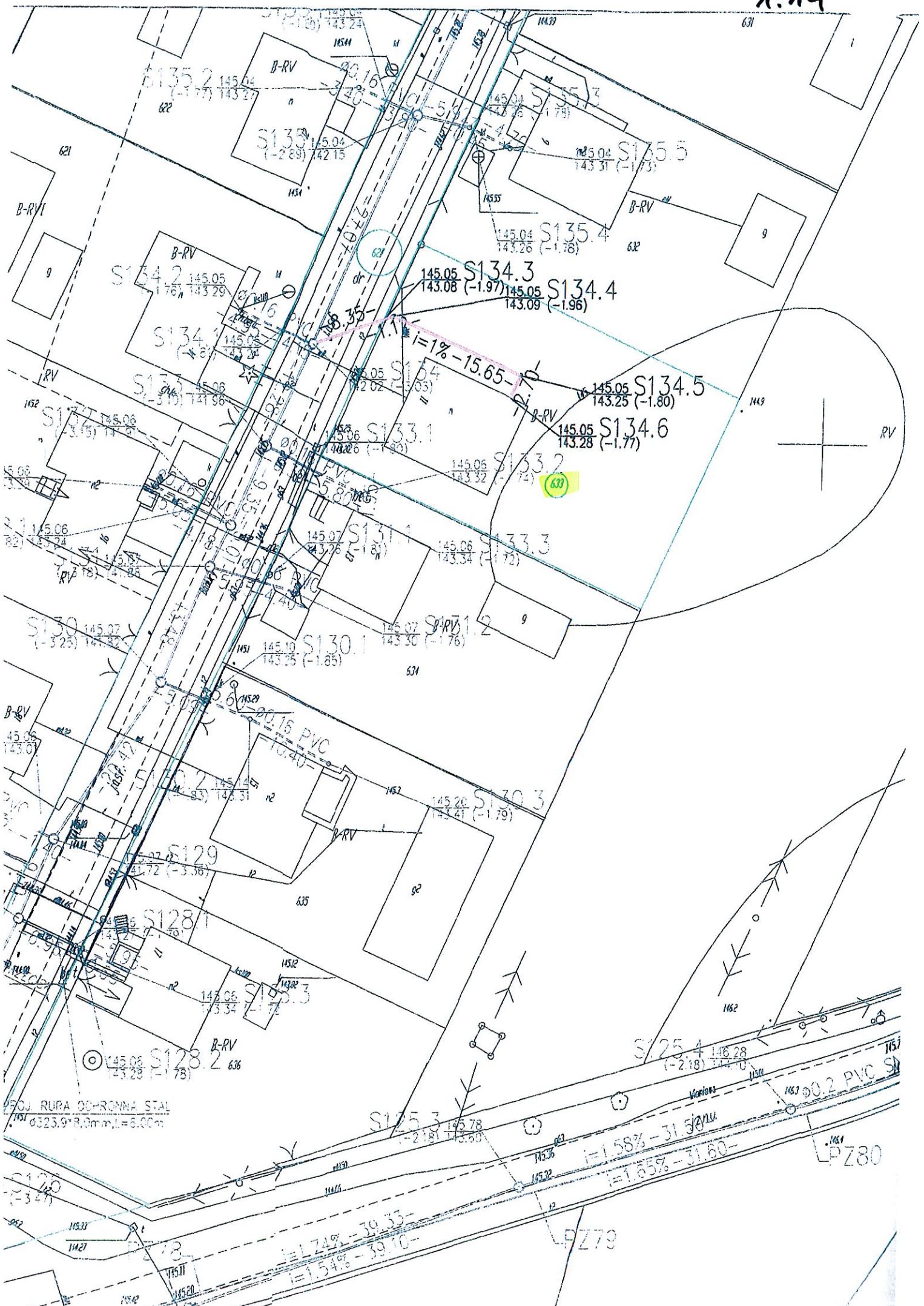

1.15



PROJ. RURA COORDONATA STAL
 9523,9*8.0m, L=6.0m

S70 145.29

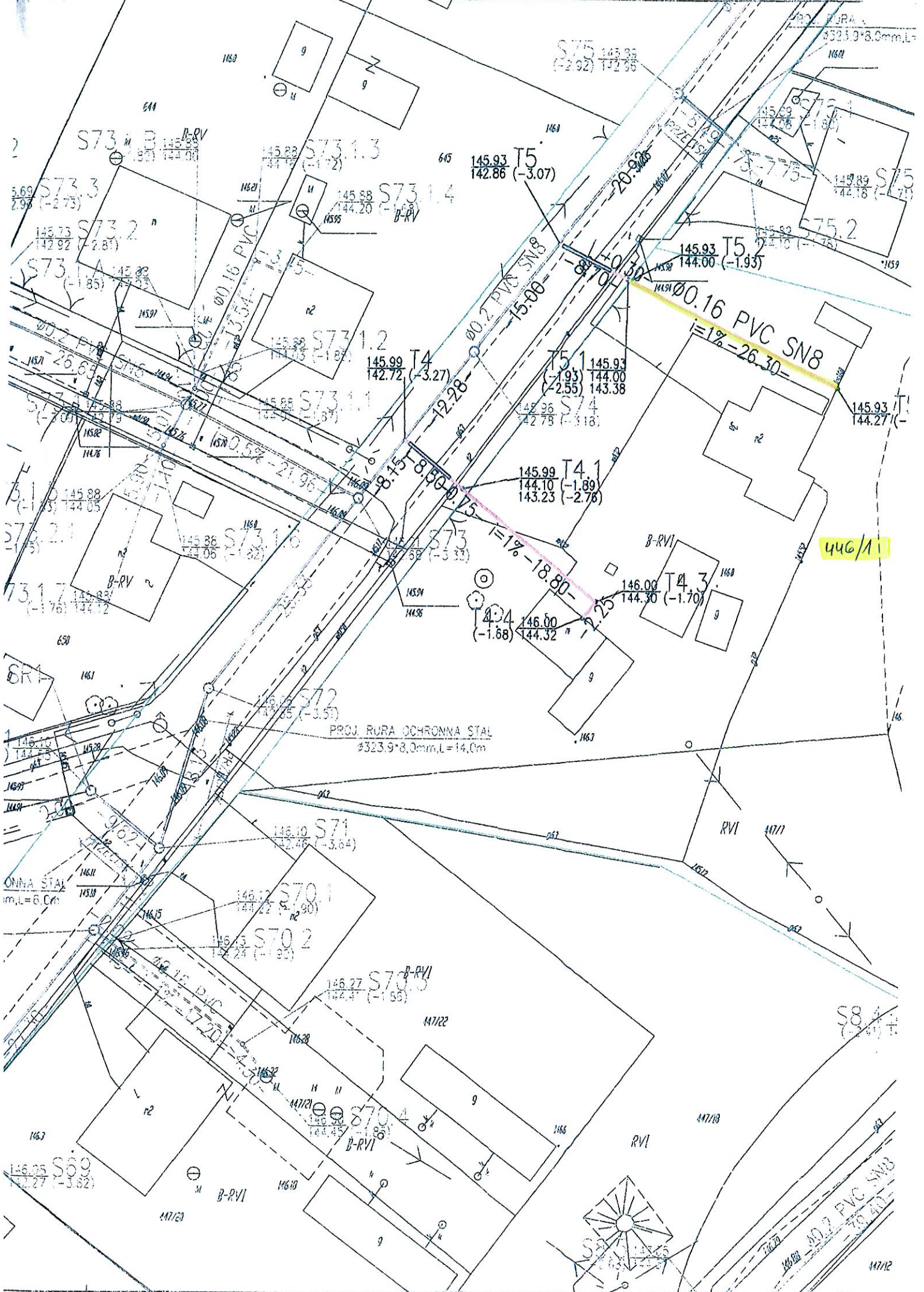

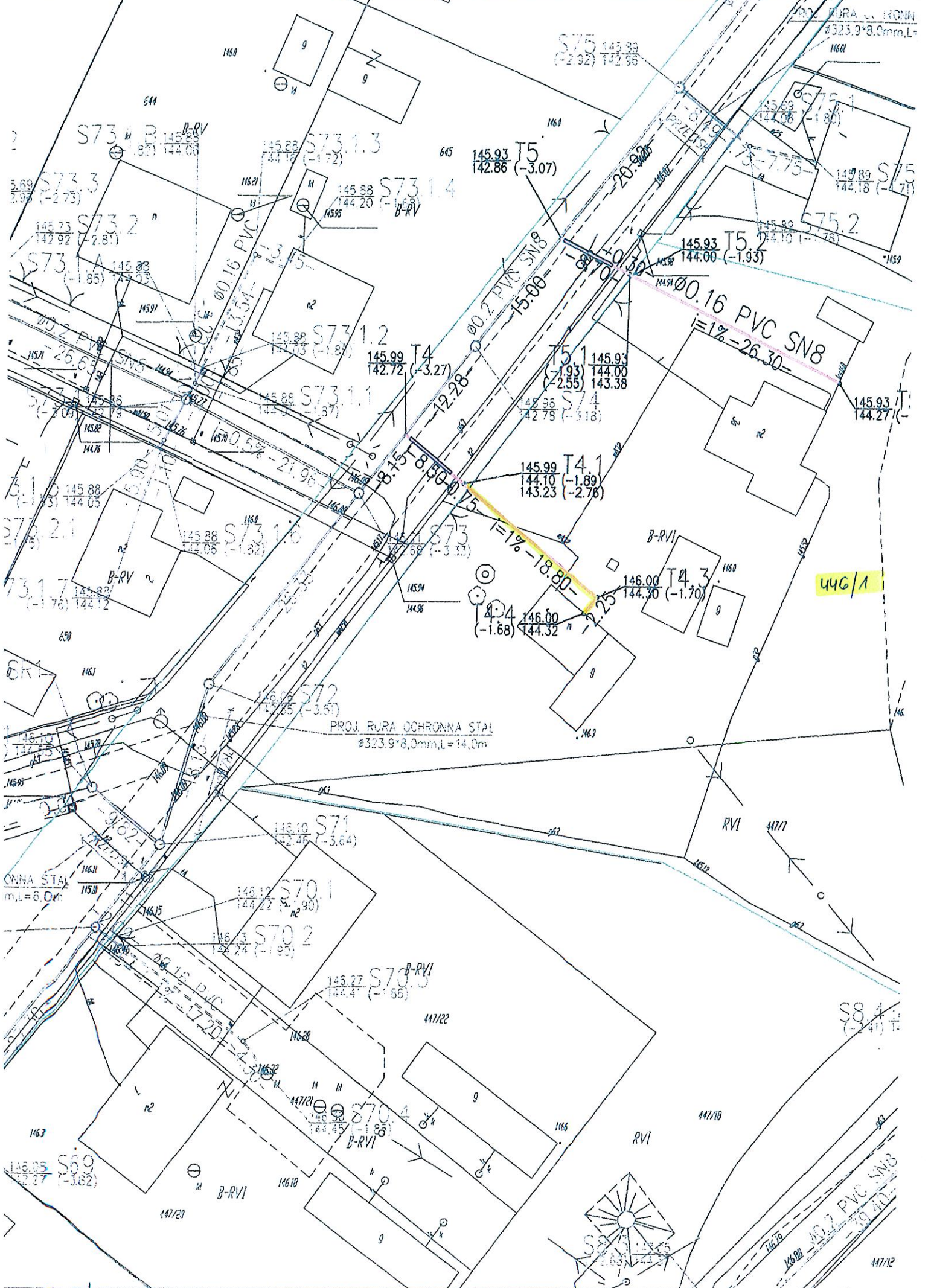

PROJ. RURA OCHRONNA STAL
 Ø323.9*8.0mm, L=14.0m

446/1



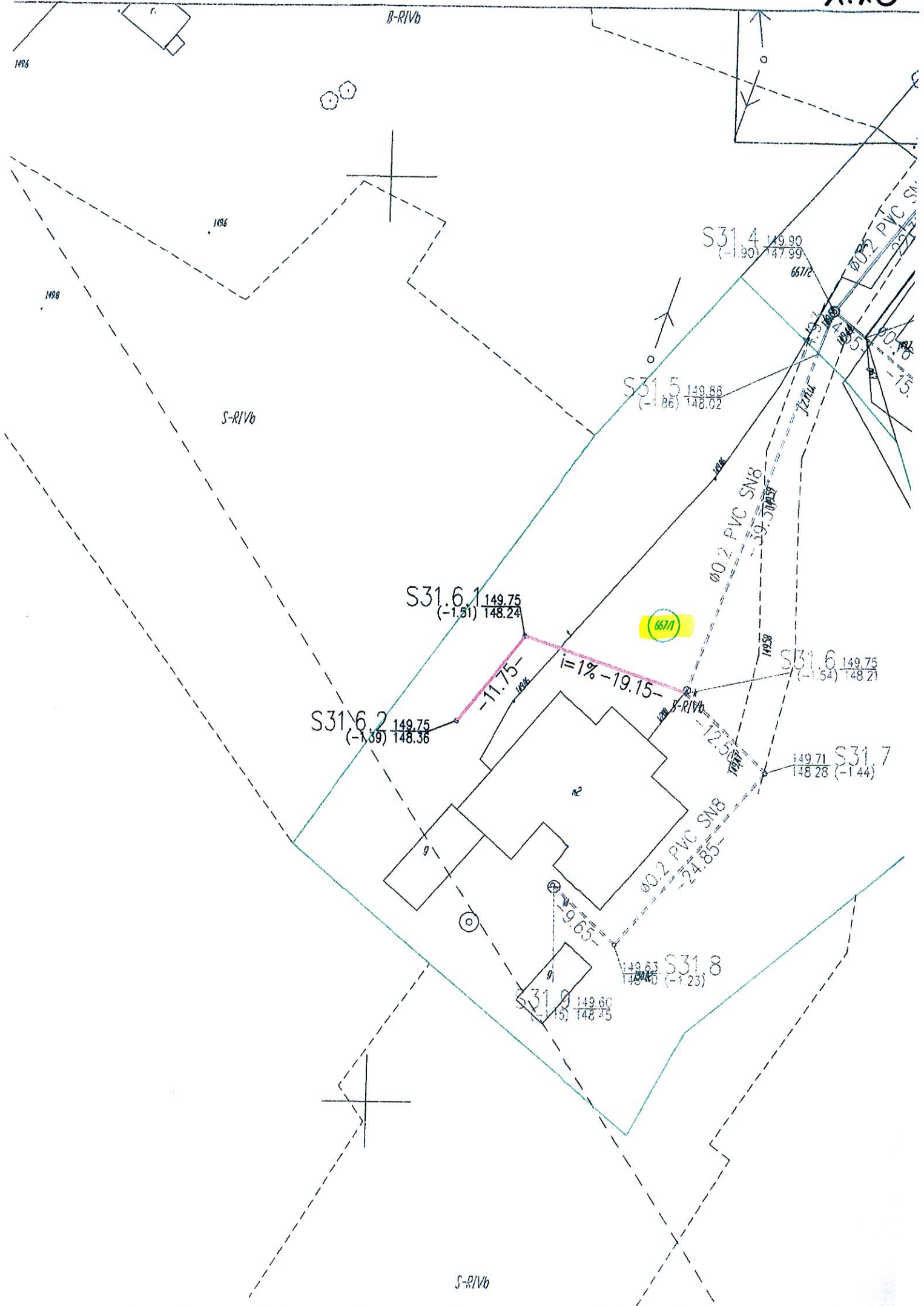

1496

B-RIVb

1496

1498

S-RIVb

S31.4 149.90
(-1.90) 147.99

S31.5 149.88
(-1.86) 148.02

S31.6.1 149.75
(-1.51) 148.24

6671

S31.6 149.75
(-1.54) 148.21

S31.6.2 149.75
(-1.39) 148.36

149.71 S31.7
148.28 (-1.44)

149.63 S31.8
148.40 (-1.23)

S31.9 149.60
148.45 (-1.15)

S-RIVb

1.19
1.20

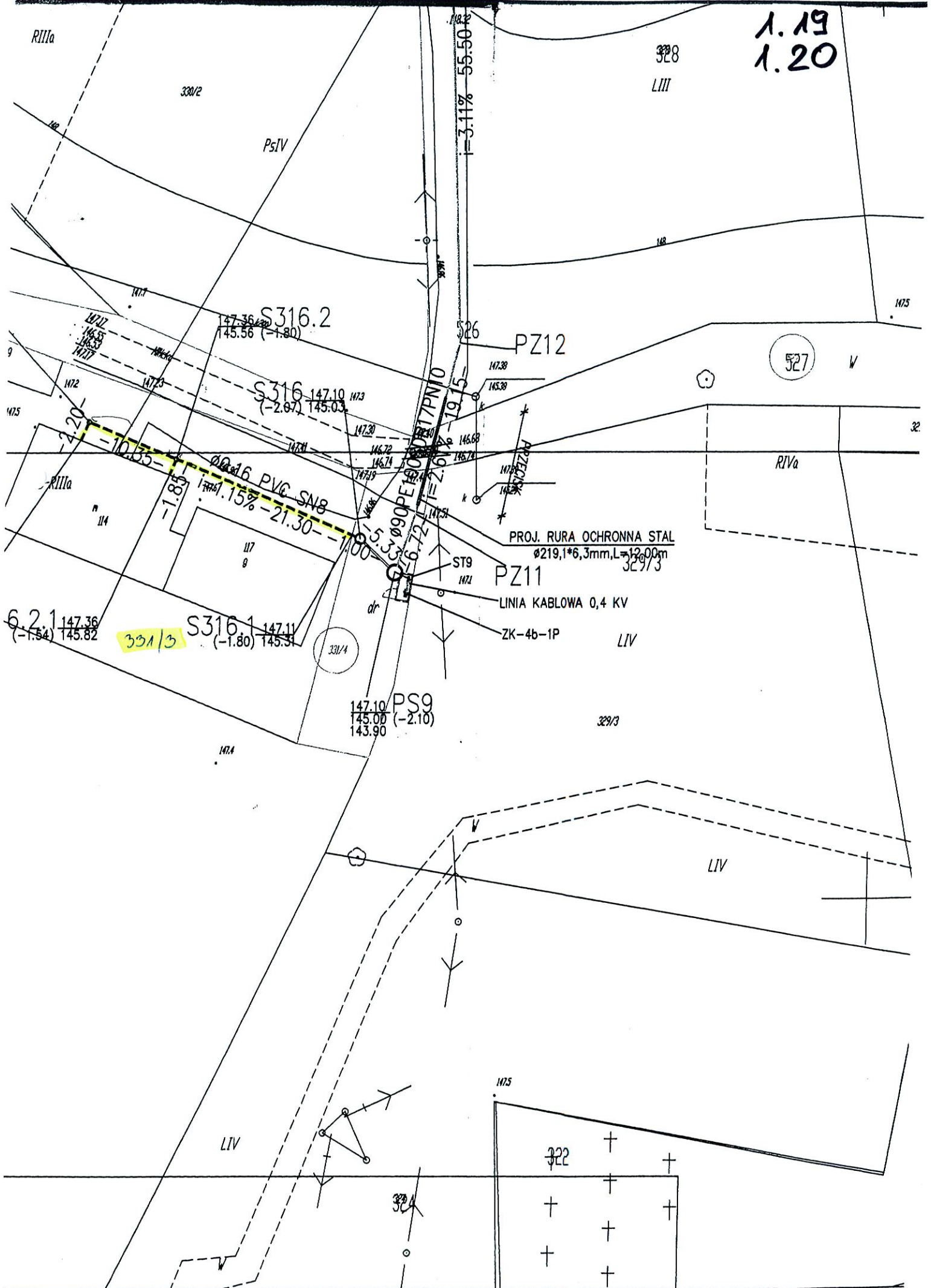

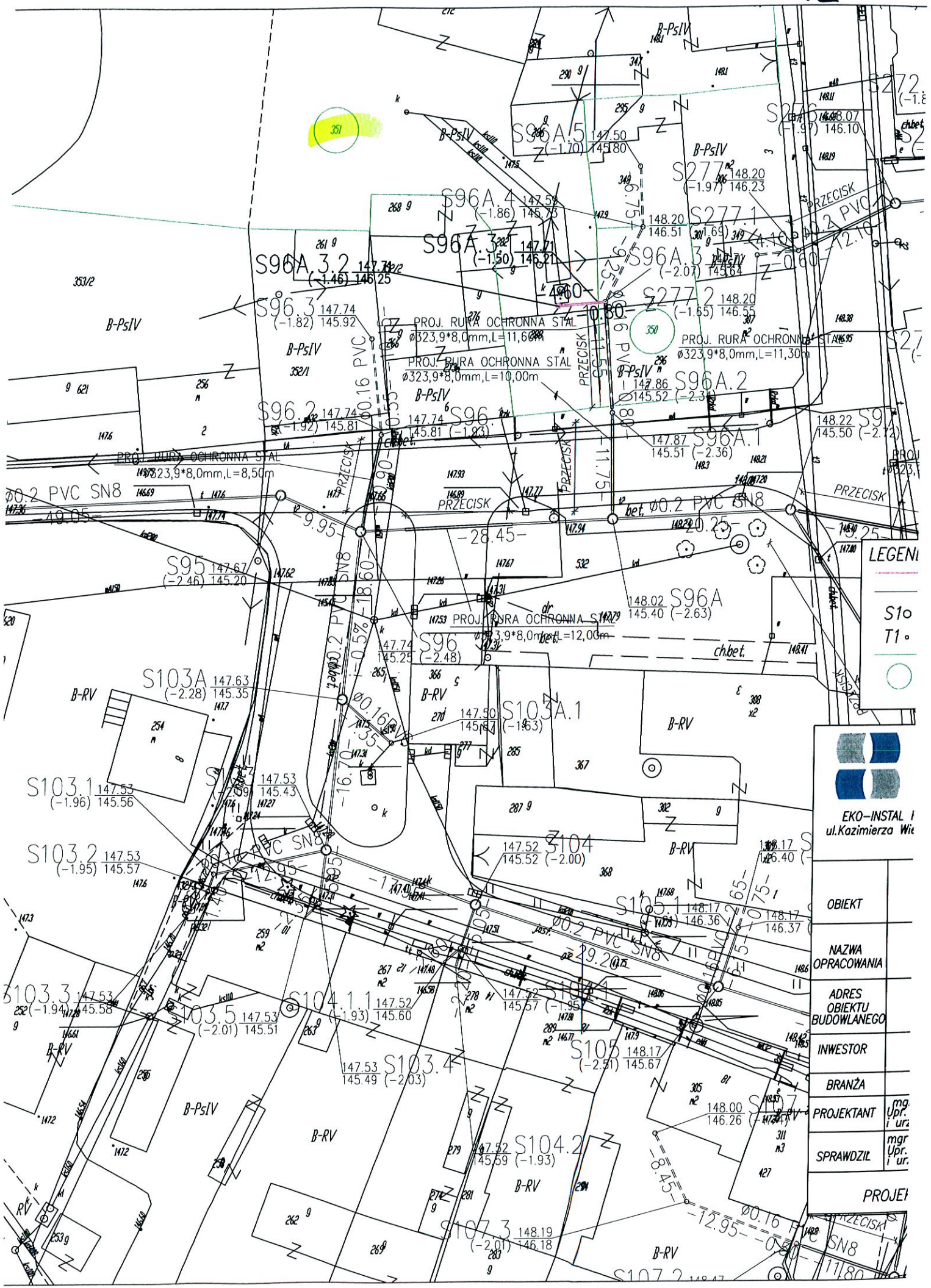

- S10
- T10

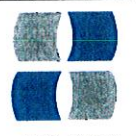

EKO-INSTAL I
ul. Kazimierza Wit

OBIEKT	
NAZWA OPRACOWANIA	
ADRES OBIEKTU BUDOWLANEGO	
INWESTOR	
BRANZA	
PROJEKTANT	mgr Upr. i urz.
SPRAWDZIŁ	mgr Upr. i ur.
PROJEKT	